



JRSDRIVE
to help you work better...



STAR EXPORT HOUSE
Recognised by Govt. of India.



Eastman®
to help you work better...



NO-ECFL-22.3
PRICE LIST
Reprinted & Corrected
W.E.F. 01/04/2022

Dear Channel Partners

Eastman Cast & Forge Ltd. commenced its Production in 1990 is a part of Eastman Group. Other Companies being Eastman Industries Ltd. with its subsidiary Eastman Auto & Power Ltd. Eastman Group achieve a turnover for Rs. 1359 Crore net of GST during April'20 - March'21. ECFL enjoys companies of scale with its 44000 sq. yard area; our manufacturing capability is over 24 million of tools per annum.

We are suppliers to OEM's like John Deere, ISUZU, Mahindra & Mahindra, CNH (New Holland), Tafe, Eicher, Ashok Leyland, Tata Motors Ltd., Sonalika, TVS and VFT.

We have strong network of 25+ Distributors, 600+ Dealers & 6 Showrooms across India for Hand Tools, Power Tools, OEM tool kits and Cleansing Solutions with 7+ Authorized Service Centers to provide service at Customer's door step and touch points in 28 Countries for Export in Europe, Asia, & CIS such as Russia, Ukraine etc.

Our focus is on Institutional Sales wherein, 9 registrations with top of the line utilities in Country has been done and another 21 registrations are in progress to help our Channel Partners to supply tools.

Every year we are introducing around 52 new items which are adapted after market research. This will help us to achieve your goal, your sales target year after year as a Channel Partner.

We are in the process of Excellence in manufacturing by way of technology upgradation. Also we are creating practices and processes to help you "Ease of doing Business with ECFL."

As India is making giant strides in the twin areas of digitization and ultra-technology, we are generating various analytical reports from these databases for betterment of our channel ecosystem.

We will help each other to win together.

Sincerely Yours

J.R. SINGAL

Managing Director

INDEX

S. NO.	PRODUCT	PAGE NO.
1.	DOE JAW SPANNER & COMBINATION SPANNER	1
2.	RING SPANNER, WHEEL SPANNER & RATCHET SPANNER	2
3.	FLARE NUT SPANNER, SINGLE OPEN END SPANNER & COMBINATION SPANNER	3
4.	SLOGGING SPANNER, TUBULAR BOX SPANNER, Y-HANDLE, CROSS WHEEL SPANNER, L-TYPE SPANNER & TOMMY BARS	4
5.	PIPE WRENCHS, ADJUSTABLE WRENCHS, C CLAMP, C-CLAMP PLIER, CHISEL & COBBLER PINCER	5
6.	COMBINATION PLIERS, SIDE CUTTING PLIER, LONG NOSE PLIER, CIRCLIP PLIERS, WIRE STRIPPER, WATER PUMP PLIER & LOCK GRIP PLIERS	6
7.	ALL TYPES OF HAMMERS	7
8.	SCREW DRIVERS & SCREW DRIVER SETS	8
9.	GREASE BUCKET PUMP, BARREL PUMP, OIL CAN, GREASE GUN, JACKS, TYRE LEVER & OIL FILTER WRENCH	9
10.	ALLEN KEYS	10
11.	PRUNNING SHEARS, PVC PIPE CUTTER, AVIATION SNIP, BOLT CUTTERS & TIN CUTTERS	11
12.	IMPACT DRIVERS, MAGNETIC BITS, LEATHER & CENTER PUNCH	12
13.	TOOL BOXES, TOOL TROLLEY & T-HANDLE SOCKET WRENCHES & SETS	13
14.	HAND RIVETER, SPIRIT LEVEL, HACKSAW FRAME, & BLADE, TORQUE WRENCH & PRECISION SCREW DRIVER SETS	14
15.	SOCKET & SOCKET SETS	15-17
16.	RATCHET, SLIDING BAR, L HANDLE, EXTENSION BAR & ADAPTORS	18
17.	NON SPARKING TOOLS	19-20
18.	POWER TOOLS & ACCESSORIES	21-24
19.	OEM TOOL KITS	25-26

LAUNCHING SOON



***IMAGES ARE FOR REFERENCE ONLY**

DOE JAW SPANNERS - CRV



E-2001

IS:2028:2004 | CHROME VANADIUM STEEL | Chrome Plated

HSN-82041110



ITEM CODE	SIZE MM	PRICE EACH ₹	ENGLISH WW	PRICE EACH ₹	SIZE SAE	PRICE EACH ₹	INNER PACKING	CARTON PACKING
FSP0E0005	6x7	22.00	-	-	-	-	10	800
	8x9	35.00	-	-	-	-	10	800
	8x10	35.00	-	-	-	-	10	600
	9x11	39.00	-	-	-	-	10	600
	10x11	39.00	1/8x3/16	39.00	-	-	10	400
	10x12	40.00	-	-	-	-	10	400
	10x13	51.00	-	-	-	-	10	400
	11x12	46.00	-	-	-	-	10	400
	11x13	49.00	-	-	-	-	10	400
	12x13	46.00	3/16x1/4	46.00	7/16x1/2	40.00	10	300
	12x14	50.00	-	-	-	-	10	400
	14x15	52.00	1/4x5/16	51.00	1/2x9/16	46.00	10	300
	13x16	60.00	-	-	-	-	5	200
	13x17	65.00	-	-	-	-	5	200
	14x17	66.00	-	-	-	-	5	200
	16x17	65.00	5/16x3/8	66.00	-	-	5	200
	-	-	5/16x7/16	73.00	-	-	5	200
	17x19	80.00	-	-	-	-	5	100
	18x19	80.00	3/8x7/16	86.00	-	-	5	150
	18x21	86.00	-	-	-	-	5	100
	19x22	87.00	-	-	3/4x5/8	71.00	5	100
	20x22	99.00	7/16x1/2	99.00	-	-	5	100
	21x23	130.00	-	-	-	-	5	100
	22x24	132.00	-	-	-	-	5	75
	-	-	7/16x9/16	123.00	-	-	5	100
	24x26	156.00	1/2x9/16	150.00	-	-	5	80
	24x27	157.00	-	-	-	-	5	80
	25x28	175.00	9/16x5/8	172.00	-	-	5	60
27x32	216.00	11/16x9/16	203.00	-	-	5	60	
30x32	214.00	5/8x3/4	204.00	-	-	5	60	

JUMBO SIZES

ITEM CODE	SIZE MM	PRICE EACH ₹	ENGLISH WW	PRICE EACH ₹	INNER PACKING	CARTON PACKING
FSP0E0005	32x36	386.00	3/4x7/8	393.00	5	30
	34x36	499.00	-	-	5	30
	34x38	499.00	-	-	5	30
	36x38	504.00	-	-	5	30
	36x41	504.00	7/8x1	501.00	5	30
	41x46	653.00	1x1-1/8	653.00	5	30
	-	-	1-1/8x1-1/4	879.00	5	30
	46x50	923.00	-	-	5	30
	50x55	1843.00	-	-	5	30
	55x60	2466.00	-	-	5	30

ITEM CODE	SET NO.	CONTENTS	PRICE EACH ₹	INNER PACKING	CARTON PACKING
METRIC SIZES (MM) - BOX PACKING					
KIT-03-60M		6x7, 8x9, 10x11, 12x13, 14x15, 16x17	235.00	1	60
KIT-3-80M		6x7, 8x9, 10x11, 12x13, 14x15, 16x17, 18x19, 20x22	392.00	1	40
KIT-03-100M		6x7, 8x9, 10x11, 12x13, 14x15, 16x17, 18x19, 20x22, 21x23, 24x27	632.00	1	15
KIT-3/101M	Special Kit	6x7, 8x9, 10x11, 12x13, 14x15, 16x17, 18x19, 20x22, 24x27, 30x32	726.00	1	10
KIT-03/121M		6x7, 8x9, 10x11, 12x13, 14x15, 16x17, 18x19, 20x22, 21x23, 24x27, 25x28, 30x32	999.00	1	12
WITH WORTH SIZES (WW) - BOX PACKING					
KIT-03/60W		5.16x3/8, 3/8x7/16, 7/16x1/2, 1/2x9/16, 9/16x5/8, 5/8x3/4	355.00	1	30
KIT-03/90W		1/8x3/16, 3/16x1/4, 1/4x5/16, 5/16x3/8, 3/8x7/16, 7/16x1/2, 1/8x3/16, 3/16x1/4, 1/4x5/16	837.00	1	12

ITEM CODE	SET NO.	CONTENTS	PRICE EACH ₹	INNER PACKING	CARTON PACKING
METRIC SIZES (MM) - KIT ROLL PACKING					
KIT-03/60MH		6x7, 8x9, 10x11, 12x13, 14x15, 16x17	263.00	5	20
KI-03/80MH		6x7, 8x9, 10x11, 12x13, 14x15, 16x17, 18x19, 20x22	452.00	3	12
KIT-03/120MH		6x7, 8x9, 10x11, 12x13, 14x15, 16x17, 18x19, 20x22, 21x23, 24x27, 25x28, 30x32	1135.00	4	8

PACKING OPTIONS



BOX PACKINGS



KIT ROLL PACKING

DOE JAW SPANNERS - ELLPTICAL PANEL - CRV



E-2002

LONG PATTERN | Full Polished | CHROME VANADIUM STEEL
MIRROR FINISH | Chrome Plated | Long Pattern

HSN-82041110



ITEM CODE	SIZE MM	PRICE EACH ₹	INNER PACKING	CARTON PACKING	ITEM CODE	SIZE MM	PRICE EACH ₹	INNER PACKING	CARTON PACKING
FSP0E0001	6x7	51.00	10	300	FSP0E0001	20x22	162.00	5	100
	8x9	53.00	10	300		21x23	206.00	5	100
	10x11	65.00	10	200		24x26	231.00	5	100
	12x13	77.00	10	200		24x27	258.00	5	50
	14x15	97.00	10	150		25x28	286.00	5	30
	16x17	121.00	5	150		30x32	356.00	5	30
	18x19	150.00	5	100		-	-	-	-

ITEM CODE	CONTENTS	PRICE EACH ₹	INNER PACKING	CARTON PACKING
METRIC SIZES (MM) - KIT ROLL PACKING				
KIT-02-60M	6x7, 8x9, 10x11, 12x13, 14x15, 16x17	452.00	5	20
KIT-02-80M	6x7, 8x9, 10x11, 12x13, 14x15, 16x17, 18x19, 20x22	740.00	3	12
KIT-02-100M	6x7, 8x9, 10x11, 12x13, 14x15, 16x17, 18x19, 20x22, 21x23, 24x27	1195.00	4	8
KIT-02-121M	6x7, 8x9, 10x11, 12x13, 14x15, 16x17, 18x19, 20x22, 21x23, 24x27, 25x28, 30x32	1836.00	3	8

FLARE NUT SPANNER

E-2259

Generally Conforming to IS : 7939 | CHROME VANADIUM STEEL
Chrome Plated

HSN-82041110



AVAILABLE IN HEX ONLY

ITEM CODE	SIZE MM	PRICE EACH ₹	INNER PACKING	CARTON PACKING
FSPFN0001	10x11	142.00	10	300
	11x13	158.00	10	300
	14x17	292.00	10	250
	19x22	353.00	5	150

BI-HEXAGONAL RING SPANNERS - SHALLOW OFFSET - CRV

E-2007

Generally Conforming to IS:2029:1981 | **CHROME VANADIUM STEEL** | HSN-82041110
Chrome Plated



ITEM CODE	SIZE MM	PRICE EACH ₹	ENGLISH WW	PRICE EACH ₹	SIZE SAE	PRICE EACH ₹	INNER PACKING	CARTON PACKING
FSPRS0003	6x7	63.00	-	-	-	-	10	300
	8x9	82.00	-	-	-	-	10	300
	10x11	90.00	1/8x3/16	88.00	-	-	10	250
	12x13	97.00	3/16x1/4	95.00	-	-	5	150
	14x15	97.00	1/4x5/16	99.00	-	-	5	150
	16x17	133.00	5/16x3/8	133.00	-	-	5	150
	17x19	155.00	-	-	-	-	5	100
	18x19	155.00	3/8x7/16	168.00	-	-	5	100
	-	-	5/16x7/16	186.00	-	-	5	100
	19x22	189.00	-	-	5/8x11/16	190.00	5	100
	-	-	7/16x1/2	174.00	-	-	5	100
	20x22	189.00	-	-	-	-	5	100
	21x23	232.00	-	-	-	-	5	50
	-	-	7/16x9/16	228.00	-	-	5	50
	24x26	257.00	-	-	-	-	5	50
	-	-	1/2x9/16	259.00	-	-	5	40
	24x27	257.00	-	-	-	-	5	50
	-	-	9/16x5/8	328.00	-	-	5	50
	25x28	315.00	-	-	-	-	5	50
	27x32	408.00	-	-	-	-	5	40
30x32	415.00	5/8x3/4	415.00	-	-	5	40	
-	-	9/16x11/16	414.00	-	-	5	40	
JUMBO SIZES								
FSPRS0001D	32x36	836.00	3/4x7/8	840.00	-	-	5	20
	34x36	949.00	-	-	-	-	1	10
	34x38	1034.00	-	-	-	-	1	10
	36x41	1050.00	7/8x1	1087.00	-	-	1	10
	41x46	3286.00	1x1-1/8	3423.00	-	-	1	10
	46x50	4024.00	1-1/8x1-1/4	4164.00	-	-	1	10
	50x55	6003.00	-	-	-	-	1	4
	55x60	6065.00	-	-	-	-	1	4

ITEM CODE	SET NO.	CONTENTS	PRICE EACH ₹	INNER PACKING	CARTON PACKING
METRIC SIZES (MM) - BOX PACKING					
KIT-07-60SD		6x7, 8x9, 10x11, 12x13, 14x15, 16x17	517.00	1	30
KIT-07-80SD		6x7, 8x9, 10x11, 12x13, 14x15, 16x17, 18x19, 20x22	797.00	1	20
KIT-07-100SD		6x7, 8x9, 10x11, 12x13, 14x15, 16x17, 18x19, 20x22, 21x23, 24x27	1245.00	1	10
KIT-07-101SD (SPECIAL KIT)		6x7, 8x9, 10x11, 12x13, 14x15, 16x17, 18x19, 20x22, 24x27, 30x32	1374.00	1	10
KIT-07-120SD		6x7, 8x9, 10x11, 12x13, 14x15, 16x17, 18x19, 20x22, 21x23, 24x27, 25x28, 30x32	1899.00	1	8
WITH WORTH SIZES (WW) - BOX PACKING					
KIT-07-60W		1/8x3/16, 3/16x1/4, 1/4x5/16, 5/16x3/8, 3/8x7/16, 7/16x1/2	752.00	1	15
KIT-07-90W		1/8x3/16, 3/16x1/4, 1/4x5/16, 5/16x3/8, 3/8x7/16, 7/16x1/2, 1/2x9/16, 9/16x5/8, 5/8x3/4	1695.00	1	8

BI HEXAGONAL RING SPANNERS - DEEP OFFSET - CRV

E-2006

Generally Conforming to IS : 2029:1981 | **CHROME VANADIUM STEEL** | HSN-82041110
Chrome Plated



ITEM CODE	SIZE MM	PRICE EACH ₹	INNER PACKING	CARTON PACKING	ITEM CODE	SIZE MM	PRICE EACH ₹	INNER PACKING	CARTON PACKING
FSPRS0004IH	6x7	69.00	10	300	FSPRS0001D	20x22	216.00	5	60
	8x9	90.00	10	300		21x23	252.00	5	60
	10x11	99.00	10	250		24x26	279.00	5	50
	12x13	105.00	5	150		24x27	279.00	5	50
	14x15	108.00	5	150		25x28	342.00	5	50
	16x17	138.00	5	100		27x32	428.00	5	40
	18x19	169.00	5	100		30x32	462.00	5	40
19x22	208.00	5	80	-	-	-	-	-	

BI HEXAGONAL RING SPANNERS - DEEP OFFSET - CRV (KIT)

E-2006

ITEM CODE	SET NO.	CONTENTS	PRICE EACH ₹	INNER PACKING	CARTON PACKING
METRIC SIZES (MM) - BOX PACKING					
KIT-06-60		6x7, 8x9, 10x11, 12x13, 14x15, 16x17	543.00	1	20
KIT-06-80		6x7, 8x9, 10x11, 12x13, 14x15, 16x17, 18x19, 20x22	913.00	1	15
KIT-06/100MH		6x7, 8x9, 10x11, 12x13, 14x15, 16x17, 18x19, 20x22, 21x23, 24x27	1391.00	1	10
KIT-06/121		6x7, 8x9, 10x11, 12x13, 14x15, 16x17, 18x19, 20x22, 21x23, 24x27, 25x28, 30x32	2100.00	1	8

RATCHET SPANNERS

E-2257

Straight | Chrome Vanadium Steel
Mirror Finish | Hardness : 42~48 HRC

HSN-82041120



ITEM CODE	SIZE MM	LENGTH mm	PRICE EACH ₹	INNER PACKING	CARTON PACKING
FGWOWSP	10	160	444.00	10	320
	11	170	444.00	10	240
	12	180	517.00	10	240
	13	190	517.00	10	160
	14	200	522.00	10	160
	15	210	522.00	10	120
	16	220	644.00	10	120
	17	230	705.00	10	90
	18	240	741.00	10	90
	19	250	772.00	10	80
	20	260	802.00	10	60
	21	280	863.00	10	60
	24	300	984.00	8	48

WHEEL SPANNERS - HEAVY DUTY - PHOSPHATE FINISH

E-2010

HSN-82041120



ITEM CODE	SIZE MM	PRICE EACH ₹	INNER PACKING	CARTON PACKING
FSPWL0003	33x33	806.00	1	10
	32x32	806.00	1	10
	30x32	806.00	1	10
	32x33	806.00	1	10
	30x33	806.00	1	10
FSPWL0001	15/16x1-1/8 SAE - M&M Arjun Tractor	694.00	1	10
	19x24 - New Holland Tractor - Short Length	573.00	1	20
	24x27 - New Holland Tractor - Short Length	634.00	1	20
FSPWL0003	24x27	806.00	1	10
	27x27 - Tata - Fully Hardened	806.00	1	10
	27x30 - Tata - Fully Hardened	806.00	1	10
	27x33 - Tata / Leyland - Fully Hardened	806.00	1	10

COMBINATION SPANNERS - RECESSED PANEL - CRV

E-2005

Generally Conforming to IS:6389:1972 | CHROME VANADIUM STEEL | Chrome Plated

HSN-82041110



ITEM CODE	SIZE MM	PRICE EACH ₹	INNER PACKING	CARTON PACKING	ITEM CODE	SIZE MM	PRICE EACH ₹	INNER PACKING	CARTON PACKING		
F03CSXXXHPRP2AX	6	42.00	10	700	F03CSXXXHPRP2AX	19	110.00	5	100		
	7	45.00	10	700		20	140.00	5	100		
	8	45.00	10	600		21	144.00	5	75		
	9	48.00	10	600		22	150.00	5	75		
	10	51.00	10	500		23	195.00	5	50		
	11	52.00	10	400		24	216.00	5	50		
	12	58.00	10	400		25	243.00	5	50		
	13	60.00	10	300		26	270.00	5	40		
	14	68.00	10	250		27	309.00	5	40		
	15	84.00	5	150		28	330.00	5	40		
	16	88.00	5	150		29	404.00	5	30		
	17	88.00	5	125		30	404.00	5	30		
	18	105.00	5	100		32	486.00	5	30		
	SAE SIZES					SAE SIZES					
	FSPC50008-IH	15/16	178.00	5		100		1-1/8	276.00	5	30
	JUMBO SIZES					JUMBO SIZES					
	FSPCS0001-RF	34	940.00	5		20		46	2206.00	1	10
		36	1157.00	5		20		50	2808.00	1	10
38		1204.00	5	20							
41		1667.00	5	10							



ITEM CODE	SET NO.	CONTENTS	PRICE EACH ₹	INNER PACKING	CARTON PACKING
METRIC SIZES (MM) - BOX PACKING					
	KIT-05-60M	8, 10, 12, 13, 14, 17	353.00	1	20
	KIT-05-80M	8, 9, 10, 11, 13, 14, 17, 19	507.00	1	20
	KIT-05-120M	6, 7, 8, 9, 10, 11, 12, 13, 14, 17, 19, 22	795.00	1	15
	KIT-05-140M	8, 9, 10, 11, 12, 13, 14, 15, 16, 17, 19, 21, 22, 24	1224.00	1	10
	KIT-05-250M	6, 7, 8, 9, 10, 11, 12, 13, 14, 15, 16, 17, 18, 19, 20, 21, 22, 23, 24, 25, 26, 27, 28, 30, 32	3726.00	1	4
		Tray PACKING KE 2005-260HS	4281.00	1	4

SPECIAL PACKING FOR COMBINATIONS

26 PIECES SET



COMBINATION SPANNERS - ELLIPTICAL PANEL - CRV

E-2004

Full Polished | CHROME VANADIUM STEEL | MIRROR FINISH | Chrome Plated

HSN-82041110



ITEM CODE	SIZE MM	PRICE EACH ₹	INNER PACKING	CARTON PACKING	ITEM CODE	SIZE MM	PRICE EACH ₹	INNER PACKING	CARTON PACKING	
FSPCS0001	6	57.00	10	500	FSPCS0001	16	115.00	5	150	
	7	62.00	10	500		17	131.00	5	125	
	8	65.00	10	400		18	151.00	5	100	
	9	73.00	10	400		19	168.00	5	100	
	10	77.00	10	400		20	186.00	5	100	
	11	80.00	10	300		21	225.00	5	75	
	12	88.00	10	300		22	263.00	5	75	
	13	96.00	10	300		23	300.00	5	50	
	14	106.00	10	200		24	329.00	5	50	
	15	112.00	5	150						

ITEM CODE	SET NO.	CONTENTS	PRICE EACH ₹	INNER PACKING	CARTON PACKING
METRIC SIZES (MM) - KIT ROLL PACKING					
	KIT-4-60M	8, 10, 12, 13, 14, 17	526.00	5	20
	KIT-4-80M	8, 9, 10, 11, 13, 14, 17, 19	777.00	3	12
	KIT-4-120M	6, 7, 8, 9, 10, 11, 12, 13, 14, 17, 19, 22	1235.00	4	8

COMBINATION SPANNERS - COLD PRESSED PANEL - CRV

E-2406

Generally Conforming to DIN 3113:11.87 & 899:01.80 & ISO:7738

HSN-82041110

CHROME VANADIUM STEEL | Chrome Plated



ITEM CODE	SIZE MM	PRICE EACH ₹	INNER PACKING	CARTON PACKING	ITEM CODE	SIZE MM	PRICE EACH ₹	INNER PACKING	CARTON PACKING	
FSPCSHFPL01	6	57.00	10	300	FSPCSHFPL01	16	115.00	5	150	
	7	62.00	10	300		17	131.00	5	100	
	8	65.00	10	300		18	151.00	5	100	
	9	73.00	10	250		19	170.00	5	80	
	10	77.00	10	250		20	187.00	5	80	
	11	80.00	10	250		21	226.00	5	80	
	12	88.00	10	250		22	267.00	5	80	
	13	96.00	10	300		23	301.00	5	50	
	14	106.00	10	250		24	330.00	5	50	
	15	112.00	5	150						



ITEM CODE	SET NO.	CONTENTS	PRICE EACH ₹	INNER PACKING	CARTON PACKING
METRIC SIZES (MM) - KIT ROLL PACKING					
	KE-2406-80HF	80MH	799.00	3	12
	KE-2406-120HF	120MH	1269.00	4	8

SINGLE OPEN END SPANNERS - BIG SIZES

E-2083

Selected High Carbon Steel | Chrome Plated

HSN-82041110



ITEM CODE	SIZE MM	PRICE EACH ₹	INNER PACKING	CARTON PACKING	ITEM CODE	SIZE MM	PRICE EACH ₹	INNER PACKING	CARTON PACKING
FSPSE0001	36	334.00	5	30	FSPSE0001-D	60	1824.00	5	10
	38	394.00	5	30		65	2403.00	5	10
	41	478.00	5	30		70	4422.00	2	6
	46	595.00	5	20		75	4727.00	2	6
	50	866.00	5	20		80	7277.00	2	6
	55	1315.00	5	10		85	7835.00	2	6

SLOGGING SPANNERS - OPEN END* & RING END* - CRV E-2081 (O)-2082 (R)

CHROME VANADIUM STEEL | Auto-Black Finish

HSN-82041110



E-2081					E-2082				
SIZE MM	PRICE EACH ₹ OPEN END	PRICE EACH ₹ RING END	INNER PACKING	CARTON PACKING	SIZE MM	PRICE EACH ₹ OPEN END	PRICE EACH ₹ RING END	INNER PACKING	CARTON PACKING
22	568.00	575.00	1	15	65	3712.00	3712.00	1	5
24	568.00	575.00	1	15	70	5237.00	5237.00	1	5
27	587.00	595.00	1	15	75	6622.00	6622.00	1	5
30	650.00	655.00	1	15	80	8764.00	8764.00	1	4
32	674.00	675.00	1	15	85	10409.00	9884.00	1	4
34	728.00	730.00	1	15	90	13498.00	12823.00	1	2
36	763.00	765.00	1	15	95	16773.00	16014.00	1	2
38	854.00	854.00	1	15	100	19425.00	19814.00	1	2
41	929.00	930.00	1	15	105	23267.00	23732.00	1	2
46	1400.00	1400.00	1	15	110	40432.00	41241.00	1	1
50	1559.00	1563.00	1	15	115	41657.00	42491.00	1	1
55	2116.00	2121.00	1	10	120	45027.00	45927.00	1	1
60	2614.00	2614.00	1	10					

TUBULAR BOX SPANNERS - HEAVY DUTY - ZINC PLATED E-2016

Made from Selected Steel Tubing | Zinc Plated

HSN-82041110



ITEM CODE	SIZE MM	PRICE EACH ₹	INNER PACKING	CARTON PACKING	ITEM CODE	SIZE MM	PRICE EACH ₹	INNER PACKING	CARTON PACKING
FSPTB0001-D	6x7	46.00	10	250	FSPTB0001-D	20x22	132.00	10	80
	8x9	50.00	10	250		21x23	144.00	5	30
	10x11	60.00	10	150		24x26	189.00	5	30
	12x13	66.00	10	150		24x27	195.00	5	30
	14x15	81.00	10	100		25x28	210.00	5	30
	16x17	87.00	10	100		27x32	246.00	5	30
	18x19	99.00	10	80		30x32	258.00	5	30

LIMITED SIZES AVAILABLE IN CHROME PLATED FINISH. PRICES AVAILABLE ON REQUEST



ITEM CODE	SET NO.	CONTENTS	PRICE EACH ₹	INNER PACKING	CARTON PACKING
KIT ROLL PACKING					
E-2016-06	6 Pcs.	Tubular Box Spanners : 6x7-16x17 mm Tommy Bar : 10mm Dia. x190 mm alongwith steps of 8mm & 5 mm	399.00	1	20
E-2016-08	8 Pcs.	Tubular Box Spanners : 6x7-20x22 mm Tommy Bar : 10mm Dia. x190 mm alongwith steps of 8mm & 5 mm	690.00	1	15
E-2016-12	12 Pcs.	Tubular Box Spanners : 6x7-30x32 mm Tommy Bar : 10mm Dia. x190 mm alongwith steps of 8mm & 5 mm, Tommy Bar 12mm Dia. x 250 mm	1407.00	1	4

Y-HANDLE SOCKET WRENCHES E-2220

CHROME VANADIUM STEEL & knurled Sockets

HSN-82042000

Elegant Appearance | Satin Finish
Selected Allow Steel Handle



HEAVY DUTY

ITEM CODE	SIZE MM	PRICE EACH ₹	INNER PACKING	CARTON PACKING
FYHSE-2220	8x10x12	222.00	1	60
	10x12x14	246.00	1	60

CROSS WHEEL SPANNERS - CHROME PLATED E-2012

Generally Conforming to IS:12521:1988 | SOCKET HARDENED

HSN-82041110

Selected Carbon Steel | Chrome Plated



ITEM CODE	SIZE MM	PRICE EACH ₹	INNER PACKING	CARTON PACKING
FSPCW0001-D	17x18 - 19x21	447.00	1	20
	17x19 - 21x23	447.00	1	20

L-TYPE SPANNERS - WITH OR WITHOUT LEVER E-2011

Selected High Carbon Steel

HSN-82041110

Chrome Plated



ITEM CODE	SIZE MM	PRICE EACH ₹	INNER PACKING	CARTON PACKING
FSPLT0001	18 - Indica / Ace	222.00	1	40
	19 - (With Hole) (19D)	261.00	1	30
	21 - Mahindra Scorpio (Zinc Plated)	274.00	1	30
	21 - Mahindra / Qualis (Handle Wheel Spanner - With Hole) (7)	264.00	1	30
	24 - MM	292.00	1	10
	27 - MM	315.00	1	10

TOMMY BARS FOR TUBULAR BOX SPANNERS E-2009

Chrome Plated

HSN-82041210



ITEM CODE	ROD DIA MM	LENGTH MM	PRICE EACH ₹	INNER PACKING	CARTON PACKING
FSPTM0001-D	10	190 along with steps of 8 & 5mm	57.00	10	50
FSPTM0001-D	12	250	78.00	10	50

PIPE WRENCHES - STILLSON TYPE

E-2048

Made From Selected Drop Forged Steel | Induction Hardened Teeth
Generally Conforming to IS:4003 (PART-1) - 1978

***ALSO AVAILABLE IN STEEL BODY TYPE**

*STEEL BODY TYPE SIZE IS UP TO 14/350 mm.



E-3034



***With Steel Housing**

***Only Repair**



E-2048

ITEM CODE	SIZE MM	PRICE EACH ₹	INNER PACKING	CARTON PACKING
FWRHP0001	10/ 250 mm	373.00	12	24
	12/ 300 mm	501.00	10	20
	14/ 350 mm	579.00	8	16
	18/ 450 mm	942.00	6	12
	24/ 600mm	1725.00	4	8
	36/ 900mm	3909.00	1	4

PIPE WRENCHES - RIGID TYPE

E-2049

Made from Non Breakable S.G. Cast Iron | I-Beam Handle |
Self Cleaning Threads Fully Floating Forged Hook Jaw |

HSN-82041220

Replaceable Hook & Heel Jaw | Knurled Adjustable Nut | Fully Hardened Hook & Heel Jaws



***Only Repair**

HEAVY DUTY

ITEM CODE	SIZE MM	PRICE EACH ₹	INNER PACKING	CARTON PACKING
FWRRT0001-D	12/ 300 mm	712.00	1	20
	14/ 350 mm	999.00	1	16
	18/ 450 mm	1680.00	1	12
	24/ 600 mm	2589.00	1	8
	36/ 900 mm	5532.00	1	2

COBBLER PINCER WITH NAIL PULLER

E-3031

Made From Selected Drop Forged Steel | Double Colour Sleeve

HSN-82032000



ITEM CODE	SIZE MM	PRICE EACH ₹	INNER PACKING	CARTON PACKING
FDCPSLPC	200 mm	216.00	10	60

OIL FILTER WRENCH

E-3022

- Size 225 mm & 300 mm
- Alloy Steel
- Adjustable wrench
- High quality belt
- Easy to use and

HSN-82041220



ITEM CODE	SIZE MM	PRICE EACH ₹	INNER PACKING	CARTON PACKING
E-3022	225	450.00	1	20
	300	551.00	1	20

ADJUSTABLE WRENCHES - FULLY POLISHED CHROME PLATED

E-2050

Selected Alloy Steel | Fully Hardened and Tempered |
Effortless Screw Adjustment

HSN-82041220



HEAVY DUTY

ITEM CODE	SIZE MM	PRICE EACH ₹	INNER PACKING	CARTON PACKING
E-2050	6/ 150 mm	285.00	6	120
	8/ 200 mm	381.00	6	90
	10/ 250 mm	499.00	6	60
	12/ 300 mm	661.00	6	36

ADJUSTABLE WRENCHES - PHOSPHATE FINISH

E-2051P

Selected Alloy Steel | Fully Hardened and Tempered |
Effortless Screw Adjustment

HSN-82041220



ITEM CODE	SIZE MM	PRICE EACH ₹	INNER PACKING	CARTON PACKING
FWRAD 0002-D	6/150 mm	246.00	6	120
	8/ 200 mm	312.00	6	72
	10/ 250 mm	423.00	6	36
	12/ 300 mm	543.00	6	36
	15/ 375 mm	1290.00	4	16

C-CLAMPS - DROP FORGED

E-2036

HSN-82057000



ITEM CODE	SIZE	PRICE EACH ₹	INNER PACKING	CARTON PACKING	ITEM CODE	SIZE	PRICE EACH ₹	INNER PACKING	CARTON PACKING
FPE-2036	2/50	393.00	1	25	FPE-2036	8/200	1809.00	1	10
	3/75	588.00	1	20		10/250	3465.00	1	10
	4/100	756.00	1	20		12/300	4284.00	1	10
	6/150	1065.00	1	10					

C-CLAMP PLIER

E-2253

HSN-82032000

Transparent white bag then Colour Box individual packaging.

Engraved Eastman Branding with specifications tag

Material - SELECTED ALLOY STEEL

HARDNESS 38 to 48 HRC | Length 290mm

Opening Capacity : 85.9mm

With 5mm Hex Key Control

Knurled handle



HEAVY DUTY

ITEM CODE	SIZE MM	PRICE EACH ₹	INNER PACKING	CARTON PACKING
FECCLP 275	11 / 275	1170.00	1	24

COMBINATION PLIERS

E-2020

SELECTED ALLOY STEEL
Drop Forged | Hardened & Tempered | Fully Polished
Acetate Sleeve

HSN-82032000



ITEM CODE	SIZE MM	PRICE EACH ₹	INNER PACKING	CARTON PACKING
KIT0074	6/ 150 mm	249.00	12	72
KIT0067IH	8/ 200 mm	291.00	10	60
KIT0067IH-D	8/ 200 mm (Double Colour Black & Red)	308.00	10	60

SIDE CUTTING PLIER

E-2022

SELECTED ALLOY STEEL
Generally Conforming to IS : 4378 (PART-1): 1990

HSN-82032000



ITEM CODE	SIZE MM	PRICE EACH ₹	INNER PACKING	CARTON PACKING
KIT 0065	6 / 150 mm	264.00	12	48

LONG NOSE PLIER

E-2023

SELECTED ALLOY STEEL
Generally Conforming to IS:5658:1990

HSN-82032000



ITEM CODE	SIZE MM	PRICE EACH ₹	INNER PACKING	CARTON PACKING
KIT 0064	6 / 150 mm	264.00	12	48

WIRE STRIPPER

E-2024

High Carbon Steel | Hardened Jaws

HSN-82032000



ITEM CODE	SIZE MM	PRICE EACH ₹	INNER PACKING	CARTON PACKING
FWSC0001	5 / 125 mm	75.00	20	120

CIRCLIP PLIERS - INTERNAL & EXTERNAL STRAIGHT

E-2034 A&C

Hardened and Tempered | Selected Alloy Steel

HSN-82032000



ITEM CODE	SIZE MM	PRICE EACH ₹	INNER PACKING	CARTON PACKING
E-2034 A	7/ 175 mm (Internal Straight)	282.00	12	72
E-2034 C	7/ 175 mm (External Straight)	282.00	12	72
E-2032 A	9/ 225 mm (Internal Straight)	570.00	10	60
E-2032 C	9/ 225 mm (External Straight)	570.00	10	60
E-2033 A	13/ 325 mm (Internal Straight)	1098.00	5	40
E-2033 C	13/ 325 mm (External Straight)	1098.00	5	40

WATER PUMP PLIER - BOX JOINT TYPE

E-2030A

SELECTED ALLOY STEEL | Painted | Drop Forged | Hardened & Tempered Jaws

HSN-82032000



ITEM CODE	SIZE MM	PRICE EACH ₹	INNER PACKING	CARTON PACKING
FSPWP0001	10 / 250 mm	271.00	12	48

WATER PUMP PLIER - SLIP JOINT TYPE - CRV

E-2030B & C

CHROME VANADIUM STEEL | Chrome Plated | Drop Forged
Hardened & Tempered Jaws | Dip Epoxy Sleeves

HSN-82032000



ITEM CODE	SIZE MM	PRICE EACH ₹	INNER PACKING	CARTON PACKING
E-2030-B	10 / 250 mm (with Sleeves)	232.00	12	48
E-2030-C	10 / 250 mm (without Sleeves)	232.00	12	48

LOCK GRIP PLIER CRV

E-3035

Eastman box individual packaging.

HSN-82032000

Eastman Branding with specifications tag
Material Alloy Steel | HARDNESS 45 to 55 HRC
Length 225mm | Opening Capacity : 40mm



ITEM CODE	SIZE MM	PRICE EACH ₹	INNER PACKING	CARTON PACKING
FDLGPSC0001	10/250 (E-3035)	474.00	1	48

LOCK GRIP PLIER CRV

E-2252

Eastman box individual packaging.

HSN-82032000

Eastman Branding with specifications tag
Material Alloy Steel | HARDNESS 45 to 55 HRC
Length 225mm | Opening Capacity : 40mm



ITEM CODE	SIZE MM	PRICE EACH ₹	INNER PACKING	CARTON PACKING
FECLJP-250	10/250 (Professional Quality - E-2252)	810.00	1	48

CIRCLIP PLIER 7" - INTERNAL & EXTERNAL BENT

E-2034 B-D

Hardened and Tempered | Selected Alloy Steel

HSN-82032000



ITEM CODE	SIZE MM	PRICE EACH ₹	INNER PACKING	CARTON PACKING
E-2034 B	7/ 175 mm (Internal Bent)	282.00	12	72
E-2034 D	7/ 175 mm (External Bent)	282.00	12	72

CLAW HAMMER

E-2061

Drop Forged Steel | Induction Hardened
Seasoned Wood Handle

HSN-82052000



ITEM CODE	SIZE GMS.	PRICE EACH ₹	INNER PACKING	CARTON PACKING
FHMCL0001D	500	333.00	4	36

BALL PEIN HAMMERS - AMERICAN TYPE & CROSS PEN HAMMERS

E-2064-65

Drop Forged Steel | Induction Hardened
Seasoned Wood Handle | Polished Hitting Face

HSN-82052000



ITEM CODE	SIZE GMS.	PRICE EACH ₹	INNER PACKING	CARTON PACKING
FHMCP0001	100	185.00	6	48
	200	210.00	6	48
	300	258.00	6	48
	500	318.00	4	36
	600	372.00	4	36
	800	441.00	2	24

SLEDGE HAMMERS WITH WOODEN HANDLE

E-2440

Drop Forged Steel | Induction Hardened
Seasoned Wood Handle | Polished Hitting Face

HSN-82052000



ITEM CODE	SIZE GMS.	PRICE EACH ₹	INNER PACKING	CARTON PACKING
FDSHFL	2lb / 900 gms	390.00	4	16
	3lb / 1350 gms	550.00	4	16
	4lb / 1800 gms	714.00	2	8
	6lb / 2700 gms	1224.00	1	2
	8lb / 3600 gms	1542.00	1	2
	10lb / 4500 gms	1866.00	1	2
	12lb / 5400 gms	2187.00	1	2
	14lb / 6300 gms	2508.00	1	2
	16lb / 7200 gms	2730.00	1	2
	18lb / 8100 gms	3228.00	1	2

SLEDGE HAMMERS WITHOUT HANDLE

E-2441

Carbon Steel | Black Powder Coated | Fully Hardened
Polished Striking Head

HSN-82052000



ITEM CODE	SIZE GMS.	PRICE EACH ₹	INNER PACKING	CARTON PACKING
FHMSL 0003	2lb / 900 gms	294.00	6	32
	3lb / 1350 gms	465.00	4	16
	4lb / 1800 gms	615.00	4	10
	6lb / 2700 gms	921.00	4	8
	8lb / 3600 gms	1227.00	2	8
	10lb / 4500 gms	1506.00	2	6
	12lb / 5400 gms	1794.00	2	6
	14lb / 6300 gms	2118.00	1	4
	16lb / 7200 gms	2403.00	1	4
	18lb / 8100 gms	2850.00	1	4

SLEDGE HAMMER WITH FIBRE GLASS HANDLE

E-3036

Specially designed handle for better gripping and shock
proof application

HSN-82052000



ITEM CODE	SIZE GMS.	PRICE EACH ₹	INNER PACKING	CARTON PACKING
FESHF-2	2LB/900 gms	642.00	6	24
FESHF-3	3LB/1350 gms	1017.00	6	12
FESHF-4	4LB/1800 gms	1195.00	6	12

MACHINIST HAMMER WITH WOODEN HANDLE

E-3023

Full Polished Head

HSN-82052000



ITEM CODE	SIZE GMS.	PRICE EACH ₹	INNER PACKING	CARTON PACKING
FDMHWHFP	300	240.00	6	48
	500	339.00	4	36
	800	462.00	2	24

PLASTIC Mallet HAMMERS

E-2066

HSN-82052000



ITEM CODE	SIZE MM	PRICE EACH ₹	INNER PACKING	CARTON PACKING
FMLH0001	25	285.00	6	48
	30	366.00	4	36
	40	585.00	2	24
	50	831.00	2	24

SPARE MALLETS

E-2066-S

HSN-82052000



ITEM CODE	SIZE MM	PRICE EACH ₹	INNER PACKING	CARTON PACKING
FSML0001	25	59.00	10	100
	30	90.00	10	100
	40	157.00	5	50
	50	251.00	5	50

CHISELS - DROP FORGES

ECH-2038

HSN-82053000



ITEM CODE	SIZE MM	PRICE EACH ₹	INNER PACKING	CARTON PACKING
FCHXX 0004	12x16x150	130.00	10	150
	16x22x200	195.00	5	50
	19x25x200	228.00	5	50

SCREW DRIVERS - FLAT TIP

E-2101

Chamfered Heads | **CHROME VANADIUM STEEL**
Black Finish | Fully Heat Treated 48-52 HRC

HSN-82054000



FSDAHF0001

ITEM CODE	ROD DIMENSION	TIP DIMENSION	PRICE EACH ₹	INNER PACKING	CARTON PACKING
E-604F	6.0x100	6.0x0.9	87.00	20	200
E-606F	6.0x150	6.0x0.9	105.00	20	200
E-608F	6.0x200	6.0x0.9	111.00	20	200
E-610F	6.0x250	6.0x0.9	123.00	20	200
E-806F	8.0x150	8.0x1.2	144.00	10	100
E-808F	8.0x200	8.0x1.2	147.00	10	100
E-810F	8.0x250	8.0x1.2	156.00	10	100
E-812F	8.0x300	8.0x1.2	168.00	10	100
E-1016F	10.0x400	10.0x1.5	303.00	6	60
E-1018F	10.0x450	10.0x1.5	321.00	6	60

SCREW DRIVERS - PHILIP TIP

E-2102

Transparent **ACETATE HANDLE**
Spring Steel Blade with Magnetic Tip
Generally Confirming to IS:844:1979 PART-III

HSN-82054000



FSDAHPT0002

ITEM CODE	ROD DIMENSION	POINT	PRICE EACH ₹	INNER PACKING	CARTON PACKING
E-508P	5.0x200	1	111.00	20	200
E-604P	6.0x100	2	123.00	20	200
E-606P	6.0x150	2	129.00	20	200
E-608P	6.0x200	2	141.00	20	200
E-610P	6.0x250	2	144.00	20	200
E-806P	8.0x150	3	177.00	10	100
E-808P	8.0x200	3	192.00	10	100
E-810P	8.0x250	3	195.00	10	100

SCREW DRIVERS - ELECTRICAL PATTERN

E-2103

Transparent **ACETATE HANDLE**
Spring Steel Blade with Magnetic Tip

HSN-82054000



FSDAHEP0003

ITEM CODE	ROD DIMENSION	TIP DIMENSION	PRICE EACH ₹	INNER PACKING	CARTON PACKING
E-506E	5.0x150	6.0x0.8	90.00	20	200
E-508E	5.0x200	6.0x0.8	104.00	20	200
E-510E	5.0x250	6.0x0.8	109.00	20	200

SCREW DRIVERS - TWO IN ONE

E-2104

Transparent **ACETATE HANDLE**
Spring Steel Blade with Magnetic Tip

HSN-82054000



FSDAHR 0004

ITEM CODE	ROD DIMENSION	TIP DIMENSION	POINT	PRICE EACH ₹	INNER PACKING	CARTON PACKING
E-604R	6.0x100	6.0x0.9	2	96.00	20	200
E-606R	6.0x150	6.0x0.9	2	108.00	20	200
E-610R	6.0x250	6.0x0.9	2	132.00	20	200
E-806R	8.0x150	8.0x1.2	2	221.00	10	100

STRIKING SCREW DRIVER WITH YELLOW HANDLE

E-3029

HSN-82054000



ITEM CODE	LENGTH	PRICE EACH ₹	INNER PACKING	CARTON PACKING
E-806	8x150x1.2	180.00	10	100
E-808	8x200x1.2	192.00	10	100
E-810	8x250x1.2	197.00	10	100
E-812	8x300x1.2	213.00	10	100

SCREWDRIVERS - WITH NEON BULB (500V~)

E-2105

Transparent **ACETATE HANDLE** | Spring Steel Blade with Magnetic Tip
Generally Confirming to IS:5579:1985

HSN-82054000



HEAVY DUTY

ITEM CODE	LENGTH	PRICE EACH ₹	INNER PACKING	CARTON PACKING
ET-500	125	72.00	20	500

STUBBY REVERSIBLE WITH GREEN HANDLE

E-3033

HSN-82054000

new Launch



ITEM CODE	ROD DIMENSION	TIP DIMENSION	POINT	PRICE EACH ₹	INNER PACKING	CARTON PACKING
E-601	6x30	6.0x0.9	2	95.00	10	

8 PCS. SCREWDRIVERS KIT

E-2101A

Transparent **ACETATE HANDLE** | Spring Steel Blade with Magnetic Tip
with **NEON BULB** Tester (500V~)

HSN-82054000



ITEM CODE	CONTENTS	PRICE EACH ₹	INNER PACKING	CARTON PACKING
FSDXX0002	1 - Transparent Cellulose Acetate Handle 3 - Phillip Head No. 0, 1 & 2 3 - Flat Blade 3mm, 5mm & 6mm 1 - Poker 1 - Extension Rod	360.00	12	48

5 PCS. SCREWDRIVERS KIT

E-2101B

Transparent **ACETATE HANDLE**
Spring Steel Blade with Magnetic Tip
With **NEON BULB** Tester (500V~)

HSN-82054000



ITEM CODE	CONTENTS	PRICE EACH ₹	INNER PACKING	CARTON PACKING
FSDXX0002	1 - Transparent Cellulose Acetate Handle 2 - Phillip Head No. 0, 1 2 - Flat Blade 3mm & 5mm 1 - Poker	291.00	12	48

GREASE BUCKET PUMP

E-2261

HSN-84131110



- High pressure hand operated portable pump.
- Solid steel pump chamber & cast head.
- Quick and easy openable cover.
- 2.2 meter high pressure hose pipe fitted with accessories.
- Useful for truck, buses and machinery for greasing.

ITEM CODE	DESCRIPTION	PRICE EACH ₹	INNER PACKING	CARTON PACKING
FGGBTXX0001	5 KG. WITH TROLLEY	6678.00	1	2
	10 KG. WITH TROLLEY	7060.00	1	2
	5 KG. WITHOUT TROLLEY	5851.00	1	2
	10 KG. WITHOUT TROLLEY	6090.00	1	2
	15 KG. WITH TROLLEY	10894.00	1	2
	20 KG. WITH TROLLEY	13034.00	1	2

ROTARY BARREL PUMP

E-2262

HSN-84131110



ITEM CODE	DESCRIPTION SIZE	PRICE EACH ₹	INNER PACKING	CARTON PACKING
FRBP0001	95 mm	2280.00	1	6

WESCO TYPE OIL CANS

E-2072A

HSN-82055990

- Rigid Body
- Steel Pump
- Steel Metal Body
- Powder Coated



ITEM CODE	CAPACITY		PRICE EACH ₹	INNER PACKING	CARTON PACKING
	PINT	CC			
FOCWT 0001-D	1/4	125	165.00	10	100
	1/2	250	186.00	10	100
	3/4	375	207.00	10	50
	1	500	228.00	10	50

LEVER TYPE GREASE GUNS

E-2071A

HSN-82055910

- Rigid Body • Steel Pump
- Steel Metal Body • Powder



ITEM CODE	CAPACITY		PRESSURE PSI	PISTON	PRICE EACH ₹	INNER PACKING	CARTON PACKING
	PINT	CC					
FGGX0001-DOIM	08	120	2500	5/16	499.00	1	20
	10	300	6000	5/16	630.00	1	15
	15	445	2500	1/2	786.00	1	12
	15	445	2000	5/8	960.00	1	12
	15	445	7000	5/16	840.00	1	12

HYDRAULIC BOTTLE JACKS

E-2258

HSN-84254200



ITEM CODE	CAPACITY TON	PRICE EACH ₹	INNER PACKING	CARTON PACKING
FEHBJ	2	1575.00	1	10
	3	1905.00	1	8
	5	2160.00	1	6
	10	3326.00	1	4

HYDRAULIC FLOOR JACK

E-3017

HSN-84254200

- » Ideal for car & truck repair and tire change and garage use.
- » Built-in safety valve provides overload protection.
- » Heavy-duty steel construction provides long term durability.
- » Large steel caster and swivel casters for easy manoeuvrability.
- » Light weight for easy mobility and transport.
- » All welded steel frame construction with cast iron support arms with rust resistant finish for long tool life



ITEM CODE	CAPACITY TON	PRICE EACH ₹	INNER PACKING	CARTON PACKING
E-3017	2 High Profile	5685.00	1	1
	3 High Profile	16800.00	1	1
	3 Low Profile	18000.00	1	1

TYRE LEVER

E-3021

HSN-82041110

- Alloy Steel
- Chrome plated
- Durable
- Corrosion Resistance
- Efficient and high strength



ITEM CODE	DESCRIPTION	PRICE EACH ₹	INNER PACKING	CARTON PACKING
FDTLMF00018	TYRE LEVER - 18"	215.00	01	20
FDTLMF00020	TYRE LEVER - 20"	247.00	01	20
FDTLMF00024	TYRE LEVER - 24"	289.00	01	20

HEX ALLEN KEYS - SHORT PATTERN - CRV

EAK-2401

Chamfered Heads | **CHROME VANADIUM STEEL**
Black Finish | Fully Heat Treated 48-52 HRC

HSN-82041120



ITEM CODE	SIZE MM	PRICE EACH ₹	INNER PACKING	CARTON PACKING	ITEM CODE	SIZE MM	PRICE EACH ₹	INNER PACKING	CARTON PACKING
FHAE 2401	1.5	10.00	100	3000	FHAE 2401	1/16	11.00	100	2000
	2	10.00	100	3000		5/64	11.00	100	2000
	2.5	11.00	100	3000		3/32	12.00	100	2000
	3	12.00	100	3000		1/8	12.00	100	2000
	4	19.00	100	1000		5/32	19.00	100	1500
	5	25.00	100	1000		3/16	23.00	50	1000
	6	38.00	50	500		7/32	26.00	50	500
	8	59.00	25	250		1/4	37.00	50	600
	10	95.00	25	150		5/16	57.00	25	400
	12	171.00	10	100		3/8	95.00	25	150
	14	237.00	10	40		1/2	179.00	10	100
	17	405.00	10	40		9/16	240.00	10	60
	19	561.00	10	20		5/8	390.00	10	40
	22	1074.00	5	20		-	-	-	-
	24	1284.00	1	08		-	-	-	-
	27	2061.00	1	10		-	-	-	-
	32	3492.00	1	04		-	-	-	-
36	5580.00	1	04	-	-	-	-		

9 PCS. HEX ALLEN KEYS SETS - SHORT PATTERN - CRV

EAK-2403

Chamfered Heads | **CHROME VANADIUM STEEL**
Black Finish | Fully Heat Treated 48-52 HRC
Sliding Plastic Box Packing

HSN-82041120



ITEM CODE	CONTENTS	PRICE EACH ₹	INNER PACKING	CARTON PACKING
METRIC SIZES				
FHAE 2403	1.5, 2, 2.5, 3, 4, 5, 6, 8, 10	321.00	12	48
SAE SIZES				
FHAE 2403	1/16, 5/64, 3/32, 1/8, 5/32, 3/16, 1/4, 5/16, 3/8	321.00	12	48

HEX ALLEN KEYS - LONG PATTERN - CRV

EAK-2402

Chamfered Heads
CHROME VANADIUM STEEL
Black Finish
Fully Heat Treated 48-52 HRC

HSN-82041120



ITEM CODE	SIZE MM	PRICE EACH ₹	INNER PACKING	CARTON PACKING	ITEM CODE	SIZE INCH	PRICE EACH ₹	INNER PACKING	CARTON PACKING
FHAE 2402	1.5	16.00	25	250	FHAE 2402	5	43.00	10	400
	2	16.00	25	250		6	64.00	10	100
	2.5	17.00	25	600		8	90.00	5	150
	3	21.00	25	600		10	126.00	5	50
	4	36.00	10	400		-	-	-	-

9 PCS. HEX ALLEN KEYS SETS - LONG PATTERN - CRV

EAK-2408

Chamfered Heads | **CHROME VANADIUM STEEL**
Black Finish | Fully Heat Treated 48-52 HRC
Folding Plastic Holder Packing

HSN-82041120



ITEM CODE	CONTENTS	PRICE EACH ₹	INNER PACKING	CARTON PACKING
METRIC SIZES				
FHAE 2408	1.5, 2, 2.5, 3, 4, 5, 6, 8, 10	594.00	12	48
SAE SIZES				
FHAE 2408	1/16, 5/64, 3/32, 1/8, 5/32, 3/16, 1/4, 5/16, 3/8	594.00	12	48

T-HANDLE HEX ALLEN KEYS - LONG PATTERN - CRV

EAK-2409

Chamfered Heads | **CHROME VANADIUM STEEL**
Black Finish | Fully Heat Treated 48-52 HRC

HSN-82041120

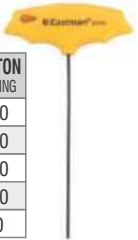

ITEM CODE	SIZE MM	PRICE EACH ₹	INNER PACKING	CARTON PACKING	ITEM CODE	SIZE MM	PRICE EACH ₹	INNER PACKING	CARTON PACKING
FT9HAKCRVB	2	77.00	10	200	FT9HAKCRVB	5	117.00	10	100
	2.5	83.00	10	200		5.5	153.00	10	100
	3	90.00	10	200		6	156.00	10	100
	4	105.00	10	200		8	204.00	10	100
	4.5	119.00	10	200		10	228.00	6	60

10 PCS - T-HANDLE ALLEN KEYS SET - LONG PATTERN - CRV

KIT-2409

Chamfered Heads
CHROME VANADIUM STEEL
Fully Heat Treated 48-52 HRC
Black Finish

HSN-82041120



ITEM CODE	CONTENTS	PRICE EACH ₹	INNER PACKING	CARTON PACKING
METRIC SIZES				
FT9HAKCRVBL-D	2, 2.5, 3, 4, 4.5, 5, 5.5, 6, 8, 10	1395.00	1	5

9 PCS BALL POINT ALLEN KEYS SET - LONG PATTERN - CRV

EAK-2406

Chamfered Heads | **CHROME VANADIUM STEEL**
Black Finish | Fully Heat Treated 48-52 HRC
Folding Plastic Holder Packing

HSN-82041120



ITEM CODE	CONTENTS	PRICE EACH ₹	INNER PACKING	CARTON PACKING
METRIC SIZES				
FHAE 2406	1.5, 2, 2.5, 3, 4, 5, 6, 8, 10	675.00	12	48
SAE SIZES				
FHAE 2406	1/16, 5/64, 3/32, 1/8, 5/32, 3/16, 1/4, 5/16, 3/8	675.00	12	48

7 PCS - STAR ALLEN KEYS SET - SHORT PATTERN - CRV

EAK-2407

Chamfered Heads | **CHROME VANADIUM STEEL**
Black Finish | Fully Heat Treated 48-52 HRC
Plastic Holder Packing

HSN-82041120



ITEM CODE	CONTENTS	PRICE EACH ₹	INNER PACKING	CARTON PACKING
FHAE 2407	T10, T15, T20, T25, T27, T30, 40	396.00	12	72

7 PCS - TEMPER STAR ALLEN KEYS SET - SHORT PATTERN - CRV

EAK-2407H

Chamfered Heads | **CHROME VANADIUM STEEL**
Black Finish | Fully Heat Treated 48-52 HRC
Plastic Holder Packing

HSN-82041120



ITEM CODE	CONTENTS	PRICE EACH ₹	INNER PACKING	CARTON PACKING
FHAE 2407H	T10, T15, T20, T25, T27, T30, 40	450.00	12	72

9 PCS SET XTRA LONG ALLEN KEY (BALL POINT & STAR)

EAK-2406-XL

Chamfered Heads | **CHROME VANADIUM STEEL**
Black Finish | Fully Heat Treated
Plastic Holder Packing

EAK-2407-XL

HSN-82041120



ITEM CODE	CONTENTS	PRICE EACH ₹	INNER PACKING	CARTON PACKING
FHAE2406-XL	BALL POINT KEY SE - XTRA LONG 1.5, 2, 2.5, 3, 4, 5, 6, 8, 10 mm	930.00	06	36
FHAE2407H-XL	STAR ALLEN KEY SET - XTRA LONG T10, T15, T20, T25, T27, T30, T40, T45, T50	1260.00	06	36

PRUNNING SHEARS WITH CURVED/STRAIGHT JAW

E-3025

HSN-82015000

- Selected Stainless Steel
- Selected Alloy Steel
- HRC 50-55



ITEM CODE	DESCRIPTION	PRICE EACH ₹	INNER PACKING	CARTON PACKING
FIPEPC0000185	PRUNNING SHEARS WITH STRAIGHT JAW 185 MM	360.00	12	60
FIPEPC0000190	PRUNNING SHEARS WITH CURVED JAW 190 MM	594.00	12	60

PVC PIPE CUTTER 42 MM & 26 MM

E-3013

Special Selected Grade of Steel Blade for Effective and long life Cutting. HSN-82034010

Blister Packed / Aluminium Body



ITEM CODE	DESCRIPTION SIZE	PRICE EACH ₹	INNER PACKING	CARTON PACKING
FEPC-26	PVC CUTTER 26 mm	510.00	12	72
FEPC-42	PVC CUTTER 42 mm	732.00	6	48
FEPC-64	PVC CUTTER 64 mm	1440.00	1	24

AVIATION SNIP

E-2254

HSN-82032000

- Blade CRV
- Overall heat Salt treated HRC 42 - 46
- Edge Salt Treated HRC 56-60
- Jaws with Anti Skid foundation.
- Cutting capacity for iron sheet 0.6 - 1mm
- Cutting capacity for stainless sheet 0.5 mm
- Double Colour Sleeve (Heavy Duty)



ITEM CODE	DESCRIPTION SIZE	PRICE EACH ₹	INNER PACKING	CARTON PACKING
FEAS-250	10/250 mm	720.00	6	36

BOLT CUTTERS - CHROME MOLYBDENUM STEEL

E-2039

Made of CHROME MOLYBDENUM | Adjustable Jaws | Heavy Rubber Grip HSN-82034090

- Blade : Chrome Molybdenum Steel
- Hand Grip : Carbon Steel Drop Forged, Double Tubular Handle
- Designed for Strong Cutting Force
- Cutting Jaws : 8.8 Nuts & Bolt
- Hardness : 55-60HRC



FBCEBC01

ITEM CODE	SIZE MM	CUTTING DIAMETER MM	PRICE EACH ₹	INNER PACKING	CARTON PACKING
EBC08	8 / 200 mm	2.5mm	630.00	6	48
EBC12	12 / 300 mm	4mm	1254.00	1	12
EBC14	14 / 350 mm	5mm	1404.00	1	12
EBC18	18 / 450 mm	6mm	1760.00	1	12
EBC24	24 / 600 mm	8mm	2400.00	1	12
EBC30	30 / 750 mm	10mm	3660.00	1	2
EBC36	36 / 900 mm	12mm	4710.00	1	2
EBC42	42 / 1050 mm	14mm	6900.00	1	2
EBC24	24 / 600 mm	8mm	2250.00	1	8

BOLT CUTTER SPARES - JAWS, PLATES, NUTS & WASHERS

E-2039-S

HSN-82034090

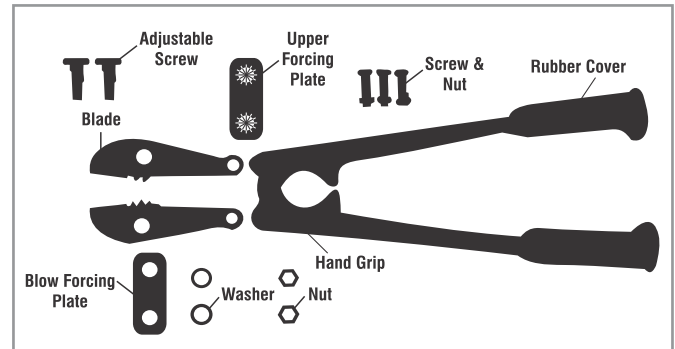

ITEM CODE	SIZE MM	PRICE EACH ₹	INNER PACKING	CARTON PACKING
FBSEBS01	12 / 300 mm	630.00	1	60
	14 / 350 mm	716.00	1	60
	18 / 450 mm	930.00	1	40
	24 / 600 mm	1435.00	1	24
	30 / 750 mm	1860.00	1	18
	36 / 900 mm	2635.00	1	12
	42 / 1050 mm	3433.00	1	1

TIN CUTTER

E-2255

Fully Drop Forged selected Alloy steel | Full polished head.

Cutting edge Induction quenched. | HRC 55-60

Cutting capacity for Iron sheet 0.6 - 1mm

Dipped Sleeve Handle

HSN-82034090



ITEM CODE	SIZE MM	PRICE EACH ₹	INNER PACKING	CARTON PACKING
FETC	8/200 mm	462.00	6	72
FETC	10/250 mm	609.00	6	36
FETC	12/300 mm	756.00	6	36
FETC	14/350 mm	906.00	6	24

IMPACT DRIVER SET - CRV BITS

EID-2500-01

Carbon Steel Handle with Socket Adapter
CHROME VANADIUM - BITS
Chrome Plated | Heat Treated
Blow Case Packing

HSN-82054000

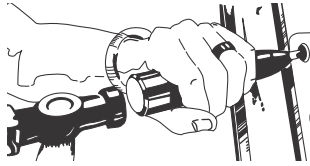

ITEM CODE	CONTENTS	PRICE EACH ₹	INNER PACKING	CARTON PACKING
FEID 2500-01	4 - 36mm x 5/16 Power Bits, Phillips No. 2 & 3 Slotted 8 & 10mm	1573.00	1	20
	1 - 1/2 Drive Impact Driver			
	1 - 1/2 Drive 5/16 Bit Holder			
	1 - Blow Case			

IMPACT DRIVER SET - CRV BITS

EID-2500-02

Carbon Steel Handle with Socket Adapter
CHROME VANADIUM - BITS
Chrome Plated | Heat Treated
Blow Case Packing

HSN-82054000



ITEM CODE	CONTENTS	PRICE EACH ₹	INNER PACKING	CARTON PACKING
FEID 2500-02	6 - 80mm x 5/16 36mm x 5/16 Power Bits, Phillips No. 2 & 3, Slotted 8 & 10mm	1662.00	1	20
	1 - 1/2 Drive Impact Driver			
	1 - 1/2 Drive 5/16" Bit Holder			
	1 - Blow Case			

IMPACT DRIVER BIT SET 36MM/80MM

EID-5001

EID-5002

Material CRV
5/16" HEX BIT IN SAND FINISH

HSN-82054000



ITEM CODE	CONTENTS	PRICE EACH ₹	INNER PACKING	CARTON PACKING
FEID-5001	5/16 Hex Bit in sand finish P#2, Ph#3, Slot 8mm, Slot 10mm *36	189.00	50	250
FEIDB-5002	5/16 Hex Bit in sand finish Ph#2, Ph#3, Slot 8mm, Slot 10mm*80	354.00	40	120

IMPACT DRIVER SET 7 PCS.

EID-1900-01

HSN-82054000

Heat Treated and chrome Plated
1/4" Hex Bit Holder With Chrome Plate (Material Carbon Steel)



ITEM CODE	CONTENTS	PRICE EACH ₹	INNER PACKING	CARTON PACKING
FEID-1900-01	Ph 1, Ph 2, Slot 4mm Slot 5mm*50mm	1287.00	12	36

DOUBLE END MAGNETIC BIT SET

E-2256

Material S2 + Chamber
Finish Mirror Copper + Magnetic
1 Pkt. contain 10 bits.

HSN-82054000



Please give order for Pkt. instead of Pcs.

ITEM CODE	CONTENTS	PRICE EACH ₹	INNER PACKING	CARTON PACKING
FEDMB	Ph2 - PH2 L65 mm	390.00	10	100
	PH2 - PH2 L110 mm	525.00	10	60
	PH2 - PH2L150 mm	855.00	10	40
	PH2 - SL6 L65 mm	390.00	10	100

SPARE BIT FOR IMPACT DRIVER SET

EIDB-5036

EIDB-5080

HSN-82054000

HSN-82054000

24 Bits/Pkt. 12 Bits/Pkt.



Please give order for Pkt. instead of Pcs.

ITEM CODE	CONTENTS	PRICE EACH ₹	INNER PACKING	CARTON PACKING
EIDB-5036	5/16 Hex Bit in Micro Copper Ph 2	969.00	10	40
EIDB-5080	5/16 Hex Bit in Material-S2 + Chamber Ph 2	975.00	10	40

LEATHER ALLOY HOLLOW PUNCH (AUTO BLACK)

E-3008

Made from Special Grade of Steel

HSN-82034010



ITEM CODE	DESCRIPTION SIZE	PRICE EACH ₹	INNER PACKING	CARTON PACKING
FPELHP0001	3x80 mm	64.00	10	-
	5x80 mm	66.00	10	-
	6x100 mm	69.00	10	-
	8x100 mm	71.00	10	-
	10x100 mm	73.00	10	-

CENTER PUNCH (AUTO BLACK)

E-3007

Made from Special Grade of Steel

HSN-82034010



ITEM CODE	DESCRIPTION SIZE	PRICE EACH ₹	INNER PACKING	CARTON PACKING
FPECP0001	8x100MM	52.00	10	150
	10x100MM	54.00	10	150
	12x125MM	72.00	10	150
	12x150MM	96.00	10	150

PLASTIC & STEEL TOOL BOX

E-2250

Plastic and steel Tool Box with Eazi Tools branding
Plastic tray with Metal Buckle

HSN-39231090



ITEM CODE	SIZE	WEIGHT PCS	INNER SIZE	OUTER SIZE	LOAD CAPACITY	PRICE EACH ₹	INNER PACKING	CARTON PACKING
FEPTB-17	17/425	1.8kgs	40.5x18.5 x16cm	41x21.5 x18.5	20kg	1950.00	1	6
FEPTB-19	19/475	2.2kgs	44.5x22x17	45x25x19.5	25kg	2550.00	1	6

TOOL TROLLEY

E-2251

- Packing with bubble bag, then honey comb box as a protector
- Front centralized safety lock.
- 3mm non slip EVC mat.
- Drawer blocking system. As protection against tipping over. One lock for all drawers.
- Ball bearing Slide.
- Full (100%) retractable drawers. More convenient to take or replace the tool.
- Powder coating exterior with great appearance. Fine film and it hardly drops.
- Mist body. Scratch - resistant. Easy to arrange.

HSN-87169090



ITEM CODE	CONTENTS	PRICE EACH ₹	INNER PACKING	CARTON PACKING
FETC-7D	L X B X H : 660 X 460 X 970 mm	45000.00	1	1
7	Net Weight : 58 KG			
Drawers	Thickness : For Sides : 0.8 mm			
	For drawers : 0.8 mm For bottom : 1.2 mm			

PLUMBER TOOL BOX

E-3030

SELECTED ALLOY STEEL | Powder Coated

HSN-73269099



ITEM CODE	CONTENTS	PRICE EACH ₹	INNER PACKING	CARTON PACKING
FDPTBP C0001	PLUMBER TOOL BOX	798.00	01	06

CANTI LEVER TYPE TOOL BOX

E-2265

Plastic and steel Tool Box with Eazi Tools branding
Plastic tray with Metal Buckle

HSN-73102910



ITEM CODE	DESCRIPTION	PRICE EACH ₹	INNER PACKING	CARTON PACKING
FTLBX0001-D	3	1860.00	1	4
	5	2250.00	1	4

T-HANDLE SOCKET WRENCHES

E-2218

Dip Insulation Sleeve
Selected Alloy Steel Handle
Chrome Vanadium Steel Socket

HSN-82042000

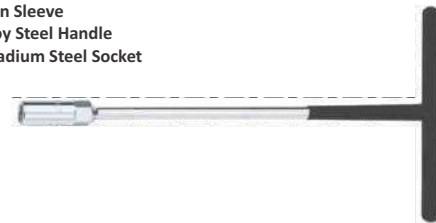

ITEM CODE	SIZE MM	LENGTH MM	PRICE EACH ₹	INNER PACKING	CARTON PACKING
FTHSE-2218	6	290	180.00	15	60
	7	290	180.00	15	60
	8	290	180.00	15	60
	9	290	183.00	15	60
	10	290	183.00	15	60
	11	290	187.00	15	60
	12	290	187.00	15	60
	13	290	187.00	15	60
	14	290	207.00	15	60
	15	290	225.00	15	60

T-HANDLE SOCKET WRENCH SET

E-2219

CHROME VANADIUM STEEL | Anti Slip KNURLED Handle
Chrome Plated

HSN-82042000



ITEM CODE	CONTENTS	PRICE EACH ₹	INNER PACKING	CARTON PACKING
FTSSE-2219	1 - T-Handle Socket Wrench Rod Dia 9.5 mm	1410.00	01	20
	7 - Hex Sockets 8, 9, 10, 11, 12, 13, 14mm			
	1 - Blow Case			

1/2" T-HANDLE RATCHET 15 PCS SET

E-3001

HSN-82042000



ITEM CODE	CONTENTS	PRICE EACH ₹	INNER PACKING	CARTON PACKING
FTSSE-3001	15pcs (12 sockets + 3 accessories)	3375.00	01	20
	Socket (8, 10, 12, 13, 14, 15, 16, 17, 19, 21, 22, 24mm)			
	1/2" T-Type Ratchet Handle 3 Pcs Extensions Handle			

HAND RIVETERS

E-3012

HSN-82055990

- 255 Nozzle : 2.4, 3.2, 4, 4.8
- 321 Nozzle : 3.2, 4, 4.8
- 509 Nozzle : 3.2, 4, 4.8, 6, 6.4



**20"
STEEL BODY**



13"



10.5"

ITEM CODE	DESCRIPTION	PRICE EACH ₹	INNER PACKING	CARTON PACKING
FEHR-255	HAND RIVETER-25MM	513.00	10	40
FEHR-321	HAND RIVETER-321MM	1380.00	6	24
FEHR-509	HAND RIVETER-509MM	1515.00	01	12

6 PCS. PRECISION SCREW DRIVER SET

E-3015

HSN-82054000

- Bit material Selected Alloy steel
- Bit surface treated, Black finished
- Handle surface treatment Nickle
- Comfortable grip and easy to use
- Corrosion resistance
- Twirl top handle
- Durable plastic storage case



ITEM CODE	LENGTH	PRICE EACH ₹	INNER PACKING	CARTON PACKING
E-3015	Phillips - 0 & 1, Slotted 1.4, 2.0, 2.4, 3.0	378.00	20	120

HACKSAW FRAME

E-2264

HSN-82029910



	DESCRIPTION	PRICE EACH ₹	INNER PACKING	CARTON PACKING
FHSTB0002-D	TUBULAR TYPE BCP FRAME	291.00	06	36
FHSTB0003-D	TUBULAR TYPE BLACK POWDER COATED	309.00	06	36

HACKSAW BLADE

E-2263

HSN-82029120



ITEM CODE	DESCRIPTION	PRICE EACH ₹ 18 TPI	PRICE EACH ₹ 24 TPI	INNER PACKING	CARTON PACKING
FHSBL0001	1/2"	10.00	10.00	100	2000
	1"	20.00	20.00	50	1000

TORQUE WRENCH BRITTOOLS TYPE, MAT FINISHED

E-3024

HSN-82041220

- 1/2" Drive Torque Range 12-68 NM, 10-50 LBF-FT/1.2-7 Kgm,
- 1/2" Drive Torque Range 25-135 NM, 20-100 LBF-F/3-14 kgm,
- 1/2" Drive Torque Range 50-225 NM, 40-160 LBF-FT/5-23 kgm,
- 1/2" Drive Torque Range 70-330 NM, 50-250 LBF-FT/7-35 kgm



ITEM CODE	DESCRIPTION	PRICE EACH ₹	INNER PACKING	CARTON PACKING
FIETWB0001268	1/2" PROFESSIONAL TORQUE WRENCH 12-68 Nm	11785.00	01	12
FIETWB00025135	1/2" PROFESSIONAL TORQUE WRENCH 25-135 Nm	12975.00	01	12
FIETWB00050225	1/2" PROFESSIONAL TORQUE WRENCH 50-225 Nm	13235.00	01	12
FIETWB00070330	1/2" PROFESSIONAL TORQUE WRENCH 70-330 Nm	16436.00	01	06

SPRIT LEVEL 300MM & 400MM WITH & WITHOUT MAGNET

E-3009

Big ends cap / 3 Viols

HSN-90153090

Available in magnet and without magnet



ITEM CODE	DESCRIPTION	PRICE EACH ₹	INNER PACKING	CARTON PACKING
FESL300-3	SPIRIT LEVEL 300MM ALUMINIUM W/O MAGNET	372.00	01	60
FESL300-3M	SPIRIT LEVEL 300MM ALUMINIUM WITH MAGNET	498.00	01	60

1/2 SQ. DRIVE SOCKETS - CRV (HEX & BI-HEX)

E-2201 E-2201B

Square Drive with Knurling
CHROME VANADIUM STEEL
Mirror Finish
Double Chrome Plated
Aluminium Painted From Inside



HSN-82042000



ITEM CODE	SIZE MM	PRICE EACH ₹	INNER PACKING	CARTON PACKING	ITEM CODE	SIZE MM	PRICE EACH ₹	INNER PACKING	CARTON PACKING
FDSE 2201-B FDSE2201	8	91.00	10	100	FDSE 2201-B FDSE2201	20	141.00	6	120
	9	91.00	10	100		21	156.00	6	120
	10	91.00	10	100		22	159.00	6	120
	11	91.00	10	100		23	175.00	6	120
	12	99.00	10	100		24	178.00	6	48
	13	99.00	10	100		25	210.00	6	48
	14	99.00	10	100		26	210.00	6	48
	15	99.00	10	100		27	228.00	6	48
	16	111.00	10	100		28	242.00	6	48
	17	115.00	10	100		29	245.00	6	48
18	115.00	6	120	30	258.00	6	48		
19	129.00	6	120	32	270.00	6	48		

SPARK PLUG SOCKET - CRV

E-2212 / E-2213

CHROME VANADIUM STEEL
Both End Hardened

HSN-82042000

F-DS-E 2213
F-DS-E 2212



ITEM CODE	DRIVE SIZE MM	LENGTH MM	PRICE EACH ₹	INNER PACKING	CARTON PACKING
E-2212	16	67	192.00	6	48
E-2213	21	67	210.00	6	48

**Why EASTMAN regular socket is better ?
Successional forging from one side to Open end to SQ**

The sectional drawings below demonstrate the difference forging between EASTMAN sockets and other makers.

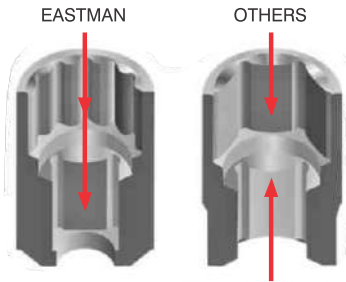

The surface is smooth by successional punching one side from Open end to SQ

The surface is burred by punching from opposite two sides.

3/4" SQ. DRIVE HEX SOCKETS* - CRV

E-2221

CHROME VANADIUM STEEL
Mirror Finish

HSN-82042000



***3/4" DRIVE BI-HEX SOCKETS TO ORDER**

ITEM CODE	SIZE MM	PRICE EACH ₹	INNER PACKING	CARTON PACKING	ITEM CODE	SIZE MM	PRICE EACH ₹	INNER PACKING	CARTON PACKING
FDSE 2221-D	22	312.00	5	50	FDSE 2221-D	34	471.00	2	36
	24	315.00	5	50		36	513.00	2	36
	27	351.00	5	50		38	564.00	2	36
	28	384.00	2	48		41	624.00	1	36
	29	402.00	2	36		46	726.00	1	36
	30	417.00	2	36		50	837.00	1	24
	32	444.00	2	36		55	1023.00	1	24
	33	468.00	2	36		60	1209.00	1	24

1/2 SQ. DRIVE IMPACT SOCKETS - CHROME MOLYBDENUM STEEL

E-2223

Square Drive | **CHROME MOLYBDENUM STEEL** | Auto-black Finish
Suitable for Working on Pneumatic & Power Tools Up to 1500 Rpm

HSN-82042000



ITEM CODE	SIZE MM	PRICE EACH ₹	INNER PACKING	CARTON PACKING	ITEM CODE	SIZE MM	PRICE EACH ₹	INNER PACKING	CARTON PACKING
FIDE 2223	8	231.00	6	60	FIDE 2223	20	258.00	6	48
	9	231.00	6	60		21	258.00	6	48
	10	231.00	6	60		22	297.00	6	48
	11	231.00	6	60		23	315.00	6	48
	12	231.00	6	60		24	330.00	6	48
	13	231.00	6	60		25	414.00	6	48
	14	231.00	6	60		26	414.00	6	48
	15	234.00	6	60		27	441.00	6	48
	16	234.00	6	60		28	441.00	6	48
	17	234.00	6	60		29	475.00	6	48
18	240.00	6	48	30	475.00	6	48		
19	246.00	6	48	32	555.00	6	48		

AIR IMPACT SOCKET 11 PCS.

E-2223 SET

CRV Auto Black Finish
Metal Tray

HSN-82042000



	SIZES	PRICE EACH ₹	INNER PACKING	CARTON PACKING
FEAS-411	10, 12, 13, 14, 16, 17, 19, 21, 22, 24+1	1795.00	1	20

1/2 SQ. DRIVE DEEP SOCKETS - CRV (HEX & BI-HEX)

E-2225

E-2225 B

CHROME VANADIUM STEEL

HSN-82042000

Square Drive
Double Chrome Plated
Mirror Finish

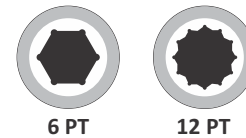

ITEM CODE	SIZE MM	PRICE EACH ₹	INNER PACKING	CARTON PACKING	ITEM CODE	SIZE MM	PRICE EACH ₹	INNER PACKING	CARTON PACKING
FDSE 2225-H FDSE 2225	8	246.00	6	60	FDSE 2225-H FDSE 2225	19	267.00	6	48
	10	246.00	6	60		21	295.00	6	48
	12	246.00	6	60		24	306.00	6	48
	13	246.00	6	60		27	363.00	6	48
	14	246.00	6	60		30	495.00	6	48
17	258.00	6	48	-	-	-	-	-	

1/2 SQ. DRIVE SOCKETS (HEX / TORX / STAR)

E-2224-2227-2228

CHROME VANADIUM STEEL
Double Chrome Plated
Mirror Finish

HSN-82042000

MADE IN TAIWAN



ITEM CODE	SIZE MM	PRICE EACH ₹	INNER PACKING	CARTON PACKING	ITEM CODE	SIZE MM	PRICE EACH ₹	INNER PACKING	CARTON PACKING
2224 FDSE2224	4	252.00	6	120	2224 FDSE2224	10	270.00	6	60
	5	252.00	6	120		12	276.00	6	60
	6	252.00	6	120		14	363.00	6	60
	7	255.00	6	120		17	405.00	6	48
	8	255.00	6	120		19	432.00	6	48
2227 FTSE2227A	T20	273.00	6	120	2227 FTSE2227A	T45	273.00	6	60
	T25	273.00	6	120		T50	285.00	6	48
	T27	273.00	6	120		T55	342.00	6	60
	T30	273.00	6	120		T60	369.00	6	60
	T40	273.00	6	60		-	-	-	-
2228 FTSE0001	E10	152.00	6	120	2228 FTSE0001	E16	152.00	6	120
	E11	152.00	6	120		E18	152.00	6	120
	E12	152.00	6	120		E20	176.00	6	120
	E14	152.00	6	120		E24	258.00	6	120
	-	-	-	-		-	-	-	-

1/2 SQ. DRIVE SOCKETS (STAR / HEX / TORX)

E-3002

HSN-82042000

EaziTools
to help you work better...
By Eastman

MADE IN TAIWAN

new Launch



ITEM CODE	SIZE MM	PRICE EACH ₹	INNER PACKING	CARTON PACKING	ITEM CODE	SIZE MM	PRICE EACH ₹	INNER PACKING	CARTON PACKING
FDSE2224-E	4	171.00	10	100	FDSE2224-E	10	186.00	10	100
	5	171.00	10	100		12	210.00	10	100
	6	171.00	10	100		14	264.00	10	100
	7	171.00	10	100		17	351.00	10	100
	8	171.00	10	100		19	405.00	10	100
FTSE2227A-E	T20	186.00	10	100	FTSE2224A-E	T40	186.00	10	100
	T25	186.00	10	100		T45	186.00	10	100
	T27	186.00	10	100		T50	195.00	10	100
	T30	186.00	10	100		T60	240.00	10	100
	-	-	-	-		-	-	-	-
FTSE0001-E	E10	126.00	10	100	FTSE0001-E	E18	126.00	10	100
	E12	126.00	10	100		E20	154.00	10	100
	E14	126.00	10	100		E24	181.00	10	100
	-	-	-	-		-	-	-	-
	-	-	-	-		-	-	-	-

40 PCS METAL-BOX BIT SET

E-3004

Metal Box
Metal Latch
S2 Bits

HSN-82054000

MADE IN TAIWAN



new Launch

ITEM CODE	CONTENTS	PRICE EACH ₹	INNER PACKING	CARTON PACKING
FEBS-40M	10MMX30MM L BITS, 10MMX75MM L BITS 7HEX: 4-5-6-7-8-10-12MM, 5 SPLINE: M5-M6-M8-M10-M12, 7 TX: T20-T25-30-40-45-50-55 2 SOCKET: HEX 1/2" & 3/8"	3360.00	01	10

1/2" & 1/4" SQ. DRIVE 94 PCS SOCKET & BIT SET

E-2301

CHROME VANADIUM STEEL
BMC Pack
Knurled Sockets
Satin Finish
Heavy Duty Grippled Handle Ratchet
Metal Latch

HSN-82042000

MADE IN TAIWAN



ITEM CODE	CONTENTS	PRICE EACH ₹	INNER PACKING	CARTON PACKING
FDSE2301	1/4" DRIVE PARTS Flank socket 4,4.5,5.5,6-14mm deep socket 6-13mm(50mm/L) Hex 3-6mm Star T8, T10, T15, T20, T25, T27 & T30 Slotted 4, 5.5, 6.5m Phillips PH.1,2 Pozidriv PZ.1,2 Ratchet handle Extn.bar 2" & 4" Sliding T handle Universal joint Spinner 6" Hex Key 1.5, 2, 2.5mm	13350.00	01	03
	1/2" DRIVE PARTS Flank socket 10-22,22,27,30 & 32mm Deep socket 14, 15, 17, 19 & 22mm (77mm/L) Spark plug socket 16mm & 20.6mm Extension bar 5" & 10" Ratchet handle 5/16" BIT (30MM/L) Hex 7, 8, 10, 12 & 14mm Star T40, 45, 50 & 55 Slotted 8, 10 & 12mm Phillips PH. 3 & 4 Pozidriv PZ.3, 4 Universal joint 1 Bit holder 1/2" DR 5/16" 1 Adaptor for extn. 3/8"DRx1/2" (M)			

9 PCS. TORX BIT SOCKET SET

E-3014

CHROME VANADIUM STEEL
Blow Case
Knurled Sockets
BCP Finish
S2 Bits

HSN-82042000

MADE IN TAIWAN



new Launch

ITEM CODE	CONTENTS	PRICE EACH ₹	INNER PACKING	CARTON PACKING
ETBS-9	Torx Bit Sockets - T20, T25, T27, T30, T40, T45, T50, T55, T60	1875.00	01	20

1/4 SQ/ DRIVE SOCKET SET - CRV

E-2260

CHROME VANADIUM STEEL

Square Drive
Double Chrome Plated
Mirror Finish



HSN-82042000

ITEM CODE	CONTENTS	PRICE EACH ₹	INNER PACKING	CARTON PACKING
FDSE 2260	46 Pcs (13 Sockets + 22 Bits + 11 Accessories)	3360.00	1	10
	• Flank Sockets- (4, 4.5, 5, 5.5, 6, 7, 8, 9, 10, 12, 11, 13, 14mm)			
	• Star Bit - (T8, T10, T15, T20, T25, T30, T40)			
	• Pozdriv - (1, 2, 3 mm)			
	• Phillip Bits - (1, 2, 3 No.)			
	• Hex Bits - (3, 4, 5, 6, 7, 8mm)			
	• U-Joint • Flexible Extension Bar • Spinner Handle			
	• Extension Rod 2" & 4" • Sliding T-Bar			
	• 72T Ratchet Handle			
	• Hex Key Wrenches 1.25, 1.5, 2, 2.5mm			
	• Slotted Bit 4, 5.5, 7mm			

3/4 SQ. DRIVE FLAT BIT SOCKETS - CRV

E-2222E

CHROME VANADIUM STEEL

Square Drive
Polished -Double Chrome Plated
Cold Forge



HSN-82042000

ITEM CODE	CONTENTS	PRICE EACH ₹	INNER PACKING	CARTON PACKING
FCSSE 2222E	14 Pcs (10 Sockets + 4 Accessories)	14150.00	1	2
	• Socket Spanners - (22, 24, 27, 30, 32, 36, 38, 41, 46, 50mm) • Ext Bars - 100 & 200mm			
	• T-Bar - 450mm • Ratchet Handle			

1/2 SQ. 24 PCS. SOCKET SET NEW

E-2202-BM

- 24pcs 1/2" dr socket wrench set 6pt (below set)
- Packing : green one-piece blow case + color sleeve
- CRV, BMC Pack



HSN-82042000

MADE IN TAIWAN

new Launch

ITEM CODE	CONTENTS	PRICE EACH ₹	INNER PACKING	CARTON PACKING
E-624-BM	24 Pcs.(18 Socket + 6 Accessories)	5130.00	1	5
	• Socket Spanners - (8, 9, 10, 11, 12, 13, 14, 15, 16, 17, 18, 19, 21, 22, 24, 27, 30 & 32mm)			
	• Ext Bars - 125 & 250mm • U-Joint • T-Bar			
	• Round Ratchet Handle with Quick Release			
• 1pc spark plug socket 21mm				

1/2 SQ. DRIVE SOCKET SETS - CRV

E-2202

MADE IN TAIWAN



HSN-82042000

ITEM CODE	CONTENTS	PRICE EACH ₹	INNER PACKING	CARTON PACKING
E-624-R (HEX) E-1224-R (BI-HEX)	24 Pcs (19 Socket + 5 Accessories) • Socket Spanners - (11, 12, 13, 14, 15, 16, 17, 18, 19, 20, 21, 22, 23, 24, 26, 27, 28, 30 & 32mm) • Ext Bars - 75 & 250mm • U-Joint • T-Bar • Round Ratchet Handle With Quick Release	5565.00	1	5
E-624-R1 (HEX) E-1224-R1 (BI-HEX)	24 Pcs (18 Socket + 6 Accessories) • Socket Spanners - (10, 11, 12, 13, 14, 15, 16, 17, 18, 19, 20, 21, 22, 23, 24, 27, 30 & 32mm) • Ext Bars - 125 & 250mm • U-Joint • T-Bar • Speeder Handle • Round Ratchet Handle With Quick Release	6150.00	1	4
E-627-R (HEX) E-1227-R (BI-HEX)	27 Pcs (22 Socket + 5 Accessories) • Socket Spanners - (8, 9, 10, 11, 12, 13, 14, 15, 16, 17, 18, 19, 20, 21, 22, 23, 24, 26, 27, 28, 30, 32mm) • Ext Bars - 75 & 250mm • U-Joint • T-Bar • Round Ratchet Handle With Quick Release	6325.00	1	4

100 PCS SOCKET & BIT SET

E-2302

CHROME VANADIUM STEEL

BMC Pack
Knurled Sockets



HSN-82042000

ITEM CODE	CONTENTS	PRICE EACH ₹	INNER PACKING	CARTON PACKING
FETK-100B	1/4" DRIVE PARTS	17845.00	01	02
	Socket 4-13 Deep Socket 8,10,11,12,13 Ratchet Handle Spinner Handle Universal Joint Extension Bar 3" Coupler Shank Slotted bits -4, -5.5, -7 Shank Phillips Bits Ph1,2&3 Shank Bit Adaptor Shank Torx Bit T15,20,30 Shank Hex Bit H3-6			
	1/2" DRIVE PARTS			
	Socket 10-15,17,19,22,24,27,30,32 Universal Joint Extension Bar 125mm Spark Plug socket 16,21mm			
OTHER TOOLS	Combination Wrench 10,11,12,13,14,15,17,19 Screw Driver (+)3x200, 2x100,2x40 (-)6x100, 6x40 Auto Tester Crimping Tool 215mm Water Pump Plier 10" Cutting Plier 7" Hex key Wrench 1.5,2,2.5 Wooden Hammer 26 Terminals Blowcase			

1/2" & 1/4" SQ. DRIVE 55 PCS. SOCKET & BIT SET

E-2303

CHROME VANADIUM STEEL

Metal Box
Knurled Sockets
Bright Chrome Finish



HSN-82042000

ITEM CODE	CONTENTS	PRICE EACH ₹	INNER PACKING	CARTON PACKING
FEBM-456	1/4" DRIVE PARTS	10650.00	01	04
	Socket 4-13mm Ratchet Handle Extension Bar 50, 150mm Universal Joint Sliding Adaptor 3/8"x1/4"			
	1/2" DRIVE PARTS			
	Socket 10-15, 17, 19, 22, 24, 27, 30 & 32 Ratchet Handle Extension Bar 3/8"x1/2"			
	5/16" BIT (30MM/L) Spark Plug Socket 16 & 21 mm Hex key Wrench 1.25, 1.5, 2, 2.5 & 3mm Bit Socket Ph1,2,SL4,5.5,H4,5,6,7,T20,25,27&30			

OVAL HEAD RATCHET HANDLE - WITH QUICK RELEASE - CRV

E-2203E

CHROME VANADIUM STEEL | Hardened Square Drive
Improved Quick Release Mechanism

HSN-82055910



ITEM CODE	DRIVE SIZE	LENGTH MM	PRICE EACH ₹	INNER PACKING	CARTON PACKING
FDSE 2203-E	1/2 (12.7)	250	1080.00	4	24

ROUND HEAD RATCHET HANDLE - WITH QUICK RELEASE - CRV

E-2204

CHROME VANADIUM STEEL | Hardened Square Drive
Unique Design Grip

HSN-82042000



ITEM CODE	DRIVE SIZE	LENGTH MM	PRICE EACH ₹	INNER PACKING	CARTON PACKING
F-DS-E 2204	1/2 (12.7)	250	1095.00	5	40
FEHV 22N	1/4 (6.3)	150	780.00	1	100

SPEEDER HANDLE - CRV

E-2205

CHROME VANADIUM STEEL
Knurling on Handle
Hardened Square Drive

HSN-82042000



ITEM CODE	DRIVE SIZE	LENGTH MM	PRICE EACH ₹	INNER PACKING	CARTON PACKING
F-DS-E 2205	1/2 (12.7)	400	720.00	6	24

UNIVERSAL JOINT* - CRV

E-2206

CHROME VANADIUM STEEL
Both End Hardened

HSN-82042000



ITEM CODE	DRIVE SIZE	LENGTH MM	PRICE EACH ₹	INNER PACKING	CARTON PACKING
F-DS-E2206	1/2 (12.7)	72	399.00	6	120
FEA305	1/4 (6.3)	40	211.00	1	100

SOCKET ADAPTORS - CRV

E-2214-15

CHROME VANADIUM STEEL | Both End Hardened

HSN-82042000



F-DS-E 2214
F-DS-E 2215

ITEM CODE	DRIVE SIZE		LENGTH MM	PRICE EACH ₹	INNER PACKING	CARTON PACKING
	MALE	FEMALE				
FDSE2214	3/8 (9.5)	1/2 (12.7)	35	195.00	10	60
FDSE2215	3/4 (19)	1/2 (12.7)	35	369.00	6	60

SWIVEL HANDLES - CRV

E-2216-17

CHROME VANADIUM STEEL

HSN-82042000

FDSE 2216
FDSE 2217



ITEM CODE	DRIVE SIZE	LENGTH MM	PRICE EACH ₹	INNER PACKING	CARTON PACKING
E-2216	1/2 (12.7)	380	999.00	6	24
E-2217	1/2 (12.7)	430	1194.00	6	24

1/2 SQ. DRIVE EXTENSION BARS - CRV

E-2207, 08, 09

CHROME VANADIUM STEEL
Fully Hardened & Tempered

HSN-82042000

F-DS-E-2207
F-DS-E-2208
F-DS-E-2209



ITEM CODE	DRIVE SIZE	LENGTH MM	PRICE EACH ₹	INNER PACKING	CARTON PACKING
E-2207	1/2 (12.7)	75	210.00	6	120
E-2208*	1/2 (12.7)	125	255.00	6	48
E-2209*	1/2 (12.7)	250	384.00	6	48

3/4 SQ. DRIVE EXTENSION BARS - CRV

E-2209

CHROME VANADIUM STEEL | Fully Hardened & Tempered

HSN-82042000



FEXTBAR 01-D

ITEM CODE	DRIVE SIZE	LENGTH MM	PRICE EACH ₹	INNER PACKING	CARTON PACKING
E-2209*	3/4 (19mm)	200	639.00	6	36
E-2209*	3/4 (19mm)	400	885.00	6	24

*DESIGN PATENT NO. 195256

SLIDING BARS - CRV

E-2210

CHROME VANADIUM STEEL | Fully Hardened & Tempered

HSN-82042000



ITEM CODE	DRIVE SIZE	LENGTH MM	PRICE EACH ₹	INNER PACKING	CARTON PACKING
FSPTH 0001	1/2 (12.7)	250	310.00	6	36
FSPTH 0001	1/2 (12.7)	300	324.00	6	36
FSPTH 0002	3/4 (19)	450	760.00	6	12
FETMV206	1/4 (6.3)	150	229.00	1	100

L-HANDLES - CRV

E-2211

CHROME VANADIUM STEEL | Fully Polished
Fully Hardened & Tempered

HSN-82042000

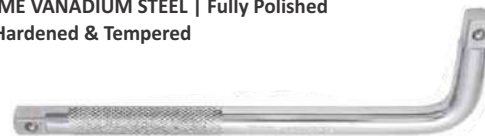

ITEM CODE	DRIVE SIZE	LENGTH MM	PRICE EACH ₹	INNER PACKING	CARTON PACKING
FSPLH 0001	1/2 (12.7)	200	231.00	6	36
FSPLH 0001	1/2 (12.7)	250	273.00	6	36
FSPLH 0001	1/2 (12.7)	300	310.00	6	36
FSPLH 0001	1/2 (12.7)	450	504.00	6	12
FSPLH 0002	3/4 (19)	450	871.00	2	12

NON SPARKING TOOLS - SAFETY FIRST

NON-SPARKING TOOL FEATURES

- These tools are used where sparking (which is normally not visible) produced while striking, rubbing or colliding of tools during working, may become hazardous or may result in Fire.
- Widely used in Oil and Gas works, Petro-Chemical Plants, Chemical Industries, Mines, Explosive manufactures, Shipyards, Pipeline construction, Armed Forces, Airports, Wine making, Pharmaceuticals, and other such places where spark can be a potential danger of fire & explosion.
- Can also be used in manufacturing and repairing of special purpose machines.
- These tools are gaining popularity because of their fine quality, competitive price & on time delivery against order.
- Eastman Non-Sparking Tools are :
 - Corrosion Resistant
 - Anti Magnetic

DOE SPANNERS

ENS-01



ITEM CODE	SIZE MM	AL-BR MRP	Be-Cu MRP	STD. PACKING	ITEM CODE	SIZE MM	A1-BR MRP	Be-Cu MRP	STD. PACKING
	6x7	766	OR	1		20x22	2335	OR	1
	8x9	910	OR	1		21x23	2487	OR	1
	10x11	1188	OR	1		24x26	4193	OR	1
	12x13	1369	OR	1		24x27	4605	OR	1
	14x15	1685	OR	1		25x28	5899	OR	1
	16x17	1809	OR	1		30x32	6675	OR	1
	18x19	2080	OR	1		-	-	-	-
SAE SIZES									
	1/4x5/16	574	OR	1		1/2x7/16	1265	OR	1
	5/16x3/8	701	OR	1		5/8x9/16	1852	OR	1
	3/8x7/16	1181	OR	1		1/2x9/16	1340	OR	1

COMBINATION SPANNERS

ENS-02



ITEM CODE	SIZE MM	AL-BR MRP	Be-Cu MRP	STD. PACKING
	6	1011.00	OR	1
	7	1151.00	OR	1
	8	1435.00	OR	1
	9	1549.00	OR	1
	10	1601.00	OR	1
	11	1741.00	OR	1
	12	1843.00	OR	1
	13	2469.00	OR	1
	14	2557.00	OR	1
	15	3320.00	OR	1
	16	3365.00	OR	1
	17	3489.00	OR	1
	18	3646.00	OR	1
	19	3920.00	OR	1
	20	4151.00	OR	1
	21	4207.00	OR	1
	22	4487.00	OR	1
	23	4993.00	OR	1
	24	5211.00	OR	1
	25	5942.00	OR	1
	26	6059.00	OR	1
	27	6369.00	OR	1
	28	7745.00	OR	1
	29	9317.00	OR	1
	30	10021.00	OR	1
	31	12624.00	OR	1
	32	13726.00	OR	1

CHEMICAL COMPOSITION & OTHER MECHANICAL & PHYSICAL PROPERTIES OF NON-SPARKING TOOLS MATERIAL

	PARAMETERS	ALUMINIUM BRONZE				
		Cu	Al	Ni	Fe	Mn
CHEMICAL PROPERTIES	Min. %	78	9	2	1	-
	Max. %	88	12	5	3	1.5
	Specific Wt.	8.45				
PHYSICAL PROPERTIES	Magnetic Properties	1.1				
	Heat Extension 20-200°C	0.000015%				
	Electrical Conductivity	8/12				
MECHANICAL PROPERTIES	Strength N/mm ²	750-850				
	Yield Point N/mm ²	450-550				
	Hardness Brinell	200/250				

RING SPANNERS

ENS-03



ITEM CODE	SIZE MM	AL-BR MRP	Be-Cu MRP	STD. PACKING	ITEM CODE	SIZE MM	AL-BR MRP	Be-Cu MRP	STD. PACKING
	6x7	815	OR	1		20x22	3782	OR	1
	8x9	1008	OR	1		21x23	3864	OR	1
	10x11	1274	OR	1		24x26	5056	OR	1
	12x13	1698	OR	1		24x27	5179	OR	1
	14x15	2138	OR	1		25x28	6043	OR	1
	16x17	2343	OR	1		30x32	8919	OR	1
	18x19	3104	OR	1		-	-	-	-
SAE SIZES									
	1/4x5/16	815	OR	1		1/2x7/16	1681	OR	1
	5/16x3/8	1063	OR	1		5/8x9/16	2589	OR	1
	3/8x7/16	1383	OR	1		1/2x9/16	1911	OR	1

SLOGGING SPANNERS - RING END

ENS-04



ITEM CODE	SIZE MM	A1-BR MRP	Be-Cu MRP	STD. PACKING	ITEM CODE	SIZE MM	A1-BR MRP	Be-Cu MRP	STD. PACKING
	32	7753	OR	1		50	18186	OR	1
	36	8877	OR	1		55	22134	OR	1
	41	13619	OR	1		60	23288	OR	1
	46	15489	OR	1		65	23600	OR	1

SLOGGING SPANNERS - OPEN END

ENS-05



ITEM CODE	SIZE MM	AL-BR MRP	Be-Cu MRP	STD. PACKING	ITEM CODE	SIZE MM	AL-BR MRP	Be-Cu MRP	STD. PACKING
	32	8057	OR	1		55	21696	OR	1
	36	9553	OR	1		60	23261	OR	1
	41	13812	OR	1		65	25357	OR	1
	46	15826	OR	1		70	30576	OR	1
	50	18646	OR	1		-	-	-	-

Note: The prices replaced with OR means These prices will be given to the consumer On Request. (OR = On Request)

SINGLE END SPANNERS

ENS-06



ITEM CODE	SIZE MM	AL-BR MRP	Be-Cu MRP	STD PACKING
	32	7768	OR	1
	36	9685	OR	1
	41	10445	OR	1
	46	11508	OR	1
	50	14495	OR	1
	55	19671	OR	1
	60	23884	OR	1
	65	29832	OR	1
	70	35122	OR	1

SCREWDRIVERS - FLAT TIP

ENS-08



ITEM CODE	SIZE MM	A1-BR MRP	Be-Cu MRP	STD PACKING	ITEM CODE	SIZE MM	A1-BR MRP	Be-Cu MRP	STD PACKING
	4x100	1843	OR	1		8x250	2865	OR	1
	6x150	2475	OR	1		10x300	3049	OR	1
	6x200	2570	OR	1		-	-	-	-

COMBINATION PLIERS

ENS-11



ITEM CODE	SIZE MM	AL-BR MRP	Be-Cu MRP	STD PACKING
	6	7194	OR	1
	7	9235	OR	1
	8	10152	OR	1

ADJUSTABLE WRENCH

ENS-12



ITEM CODE	SIZE MM	AL-BR MRP	Be-Cu MRP	STD PACKING
	6	5488	OR	1
	8	7996	OR	1
	10	9875	OR	1
	12	13070	OR	1
	15	20297	OR	1

BALL PEIN HAMMERS

ENS-07



ITEM CODE	SIZE MM	AL-BR MRP	Be-Cu MRP	STD PACKING
	230 Grms. (0.5P)	2666	OR	1
	340 Grms. (0.75P)	3299	OR	1
	440 Grms. (1.0P)	4163	OR	1
	680 Grms. (1.5P)	6129	OR	1
	900 Grms. (2.0P)	8157	OR	1
	1130 Grms. (2.5P)	10015	OR	1

CROSS PEIN HAMMERS

ENS-09



ITEM CODE	SIZE MM	AL-BR MRP	Be-Cu MRP	STD PACKING
	0.5 kg.	4911	OR	1
	1 kg.	8678	OR	1
	1.5 kg.	12982	OR	1
	2 kg.	15396	OR	1
	5 kg.	38409	OR	1

PIPE WRENCH

ENS-10



ITEM CODE	SIZE MM	AL-BR MRP	Be-Cu MRP	STD PACKING
	8/200 mm	7279	OR	1
	10/250 mm	11185	OR	1
	12/300 mm	14394	OR	1
	14/350mm	17923	OR	1
	18/450mm	26969	OR	1
	24/600mm	41230	OR	1
	36/900mm	59851	OR	1

Note: The prices replaced with OR means These prices will be given to the consumer On Request. (OR = On Request)

ROTARY & IMPACT DRILLS

Electric Drill & Screw Driver ESD-010

• With BMC Box

HSN-84672100



Drill Capacity	10 mm
No Load Speed	0-2500 RPM
Rated Input Power	500 W
Net Weight	1.700 kg.
M.R.P.	₹ 6400.00
Std Packing	5

FREE CARBON SET

Electric Drill EPD-010A

• Variable Speed • Reversible Motor

HSN-84672100



Drill Capacity	10 mm
No Load Speed	0-2800 RPM
Rated Input Power	450 W
Net Weight	1.500 kg.
M.R.P.	₹ 3900.00
Std Packing	10

FREE CARBON SET

Impact Drill EID-010C

HSN-84672100

FREE CARBON SET



Drill Capacity	10 mm
Max. Impact Rate	46400 BPM
No Load Speed	0 - 2900 RPM
Rated Input Power	550 W
Net Weight	1.800 kg.
M.R.P.	₹ 4200.00
Std Packing	10

Impact Drill | EID-013

HSN-84672100

FREE CARBON SET

• Variable Speed control with forward and reverse mode



Drill Capacity	13 mm
Max. Impact Rate	44800 BPM
No Load Speed	0 - 2800 RPM
Rated Input Power	600 W
Net Weight	2.00 kg.
M.R.P.	₹ 5000.00
Std Packing	10

Electric Drill | EPD-013 ALUMINIUM BODY

HSN-84672100



Drill Capacity	13 mm
No Load Speed	0-790 RPM
Rated Input Power	860 W
Net Weight	2.500 kg.
M.R.P.	₹ 6900.00
Std Packing	5

FREE CARBON SET

Keyless Screw Driver | EKSD-010

HSN-84672900



Chuck Size	10 mm
Rated input power	300 W
No-load speed	0 - 750r/min
Rated Frequency	50/60Hz
NW/G.W	1.400 kg.
MRP	₹ 3800.00
Std Packing	10 pcs

CORDLESS DRILL 10MM | ECD-10

HSN-84672100



Battery volt	12 V Max
Battery Capacity	1.5 Ah li-ion
No-load Speed	0-400/1400 RPM
Charge Time	80 Min.
Chuck Capacity	0.8-10mm
Max Torque	17+1 Nm
M.R.P.	₹ 6700.00
Packing	5

FREE CARBON SET

HAMMER MACHINE / DEMOLITION

Hammer Drill | EHD-020C

HSN-84672100



• With BMC Box

Drill Capacity	20 mm
Max. Impact Rate	0-5000 BPM
No Load Speed	1200 RPM
Rated Input Power	500 W
Net Weight	2.600 kg.
M.R.P.	₹ 7400.00
Std Packing	2

Hammer Drill | EHD-020N

HSN-84672100

• With Reversible Switch



• With BMC Box

Drill Capacity	20 mm
Max. Impact Rate	0-5000 BPM
No Load Speed	3900 RPM
Rated Input Power	500 W
Net Weight	2.600 kg.
M.R.P.	₹ 7650.00
Std Packing	5

in JRS Brand **NEW Launch**

26mm Hammer Drill | EHD-026

HSN-84671120

HEAVY DUTY



FREE CARBON SET

Drill Capacity	26 mm
Max. Impact Rate	0 - 4600 BPM
No Load Speed	0 - 900 RPM
Rated Input Power	710 W
Net Weight	3.4 kg.
M.R.P.	₹ 10,900.00
Std. Packing	2

Electric Hammer Drill | EHD-32N

FREE BIT INSIDE

HSN-84672100



Tool Holder	SDS +
Input Power	1250 W
No-Load Speed	800 RPM
Impact Rate	2600/min
M.R.P. (Rs.)	₹ 11,990.00
Net Weight	5.700 kg.
Std. Packing	2

Demolition Hammer | ERB-05

HSN-84671120



FREE CARBON SET

Torque	11J
Max. Impact Rate	4900 BPM
Rated Input Power	1100 W
Net Weight	6.3 kg.
M.R.P.	₹ 14,600.00
Std. Packing	1

11kg Demolition Hammer | ERB-011

• With Service Light Indicator

HSN-84671120



FREE CARBON SET

Torque	21 J
Max. Impact Rate	900-1890BPM
Rated Input Power	1500W
Net Weight	11.350kg
M.R.P.	₹ 40,200.00
Std. Packing	2

Demolition Hammer | ERB-016A

• With Steel Case Packing

HSN-84671120



FREE FLAT & POINTED CHISEL & Carbon Set

Torque	32J
Max. Impact Rate	1900 BPM
Rated Input Power	1600 W
Net Weight	15.00 kg.
M.R.P.	₹ 36,300.00
Std. Packing	1

ANGLE GRINDERS / POLISHER

Angle Grinder | EDG-100

HSN-84672900



FREE CARBON SET

Housing Outer Dia	100 mm
No Load Speed	10500 RPM
Rated Input Power	680 W
Net Weight	1.800 kg.
M.R.P.	₹ 5000.00
Std. Packing	6

Angle Grinder-Tail Type | EDG-100T

HSN-84672900



FREE CARBON SET

Max Disc Diameter	100mm
Hole Diameter of Disc	16mm
Input Power	850W
No Load Speed	11000r/min
Rated Voltage	220V
Rated frequency	50/60Hz
Net Weight	1.94kg
M.R.P.	₹ 5800.00
Std. Packing	8

Angle Grinder | EDG-100PB

HSN-84672900



FREE CARBON SET

Wheel Dia	100 mm
No Load Speed	10500 RPM
Rated Input Power	850 W
Net Weight	1.800 kg.
M.R.P.	₹ 5500.00
Std. Packing	8

Angle Grinder | EDG-100N

HSN-84672900



in JRS Brand

• Double Lock Spindle System

Wheel Dia	100 mm
No Load Speed	11000 RPM
Rated Input Power	1100 W
Net Weight	2.000 kg.
M.R.P.	₹ 5500.00
Std. Packing	9

Angle Grinder | EDG-125 N/NE*

HSN-84672900

• Variable Speed

HEAVY DUTY



FREE CARBON SET

Wheel Dia	125 mm
No Load Speed	3000-9000 RPM
Rated Input Power	1350 W
Net Weight	3.100 kg.
M.R.P.	₹ 5900.00
Std. Packing	4

• NE - Single Speed Model

Angle Grinder | EDG-180C

HSN-84672900

• Anti Vibration side handle • Quick Adjustment tool free guard

• Soft start to limit start up & reduce kick back

HEAVY DUTY



FREE CARBON SET

Wheel Dia	180 mm
No Load Speed	8500 RPM
Rated Input Power	2200 W
Net Weight	3.200 kg.
M.R.P.	₹ 10,700.00
Std. Packing	2

Electric Polisher | ESP-180N

HSN-84672900

• Variable Speed Switch



Wheel Dia	180 mm
No Load Speed	1000-3000 RPM
Rated Input Power	1350 W
Net Weight	3.200 kg.
M.R.P.	₹ 8500.00
Std. Packing	4

DIE GRINDER, HEAT GUN & BLOWER

Die Grinder | EDG-025C HSN-84672900

• Used for Grinding, Sanding, Honing, Polishing metal not plastic or wood.



Housing Outer Dia	25 mm
No Load Speed	25000 RPM
Rated Input Power	450 W
Net Weight	1.900 kg.
M.R.P.	₹ 5500.00
Std. Packing	6

FREE CARBON SET

Heat Gun | EHG-8610A HSN-84671120



Temperature Setting	Low 450° High 600°
Air Volume (LPM)	Low 300 High 500
Rated Input Power	2000 W
Net Weight	0.700 kg.
M.R.P.	₹ 3000.00
Std. Packing	8

Electric Blower | EEB-040N HSN-84672900

• Variable Speed



Air Volume	2.8m ³ /min
No Load Speed	14500 RPM
Rated Input Power	600 W
Net Weight	1.400 kg.
M.R.P.	₹ 3500.00
Std. Packing	8

FREE CARBON SET

MARBLE, METAL & WOOD CUTTERS

Marble Cutter | EMC-110A HSN-84672900 **FREE CARBON SET**



Saw Disc Dia	110 mm
No Load Speed	12000 RPM
Rated Input Power	1300 W
Net Weight	3.000 kg.
M.R.P.	₹ 5000.00
Std. Packing	4

Marble Cutter | EMC-110P HSN-84672900 **FREE CARBON SET**



Saw Disc Dia	110 mm
No Load Speed	12000 RPM
Rated Input Power	1050 W
Net Weight	2.800 kg.
M.R.P.	₹ 4500.00
Std. Packing	4

Marble Cutter | EMC-125NE HSN-84672900 **in JRS Brand**



• Base Plate without 45° inclination

Saw Disc Dia	125 mm
No Load Speed	12000 RPM
Rated Input Power	1680 W
Net Weight	3.00 kg.
M.R.P.	₹ 6100.00
Std. Packing	4

Marble Cutter | EMC-125N HSN-84672900 **in JRS Brand**



• Base Plate with 45° inclination

Saw Disc Dia	125 mm
No Load Speed	12000 RPM
Rated Input Power	1680 W
Net Weight	3.000 kg.
M.R.P.	₹ 6100.00
Std. Packing	4

Cut Off Machine | ECM-355 HSN-84615029

• Solid Rigid Base • D-Type Handle



FREE CARBON SET

Wheel Dia	355 mm
No Load Speed	3600 RPM
Rated Input Power	2400 W
Net Weight	15.00 kg.
M.R.P.	₹ 16,000.00
Std. Packing	1

Cut Off Machine | ECM-355A HSN-84615029

• Heavy duty Amature (Core Length - 78mm)
• Strong Aluminium Gear Housing
• Solid Rigid Base • D-Type Handle



HEAVY DUTY

FREE CARBON SET

Wheel Dia	355 mm
No Load Speed	3800 RPM
Rated Input Power	2400 W
Net Weight	17.00 kg.
M.R.P.	₹ 18,200.00
Std. Packing	1

Electric Router | EER-812N HSN-84672900

• With 8 & 12 mm Bits capacity



new Launch

Voltage	230 V
RPM	21000/min
Rated Input Power	1200 W
Net Weight	4.200 kg.
M.R.P.	₹ 9,500.00
Std. Packing	2

Circular Saw | ECS-185 HSN-84672200

FREE 100 BLADES & CARBON SET



Saw Disc Dia	185 mm
No Load Speed	5000 RPM
Rated Input Power	1300 W
Net Weight	4.200 kg.
M.R.P.	₹ 8500.00
Std. Packing	4

Jig Saw | EJS-060 HSN-84672200

FREE CARBON SET



Cutting Depth	25 mm
Strokes Per Min.	500 - 3000
Rated Input Power	600 W
Net Weight	2.500 kg.
M.R.P.	₹ 7100.00
Std. Packing	5

Electric Planer | EEP-082N HSN-84672900 **FREE CARBON SET**

• With BMC Box



Width of Cutter	82 mm (3¼)
No Load Speed	16500 RPM
Rated Input Power	650 W
Net Weight	3.100 kg.
M.R.P.	₹ 6700.00
Std. Packing	4

GASOLINE CHAIN SAW & PROFESSIONAL CHAIN

Gasoline Chain Saw | EPCS-5822N HSN-84678100

• Solid Rigid Base • D-Type Handle



Bar length	560 mm
Max speed	11000 RPM
Engine displacement	58 CC
M.R.P.	₹ 19,400.00
Std. Packing	2

Chain Professional | (item code EGSC, EESC)

Material : High quality special Steel
HRC 55-65

Code	Length	Type	Master Packing	M.R.P. (₹)
EGSC-22	22"	Gasoline	60	1350
EESC-18	18"	Gasoline	60	1170
EESC-16	16"	Electric	60	890



12" CHAIN SAW BRACKET

ECSB-300 HSN-84672900

• Suitable for 4" & 5" Angle Grinders



new Launch

in JRS Brand

Length	12" (300 mm)
Net Weight	1.00 kgs
M.R.P.	₹ 1490.00
Std. Packing	20

BRUSH CUTTER-4S

EBCGX4-35B HSN-84678990

Available in Side & Back pack



in JRS Brand **new Launch**

Engine Model	139 F
Displacement	35.8 CC
Engine Power	0.8 Kw/7500 r/m
Idling Speed	2800-3000 r/min
M.R.P.	₹ 24,600.00
Std. Packing	1

INDUSTRIAL PRESSURE WASHER, ELECTRIC VIBRATOR WITH ROD & PAINT SPRAY GUN

INDUSTRIAL PRESSURE WASHER EIPW-23100

HSN-84248990



Working Pressure	100 Bar
Max. Pressure	135 Bar
Discharge Rate	580 L/H
Rated Input Power	2300 W
Net Weight	17.300 kgs
M.R.P.	₹ 42,400.00
Std. Packing	1

ELECTRIC VIBRATOR - EEV-1.5

WITH 1.5 M ROD - EEVR-1.5

HSN-84678920



Rated Input Power	950 W
No Load Speed	4000 Rpm
Rated Voltage	220-240/110V
Vibration Frequency	230 Hz
Net Weight	2.4/3.2kgs
M.R.P.	₹ 6100.00
Std. Packing	5

***EXTRA 1.5 M VIBRATOR ROD ALSO AVAILABLE at M.R.P. Rs. 1,999.00**

PAINT SPRAY GUN / ITEM CODE: EPSG 827A

HSN-84242000



CUP CAPACITY	600 ml.
FEED TYPE	GRAVITY
AIR INLET	1.4"
AIR CONSUMPTION	8-9 cfm
RATED PRESSURE	43-57 PSI
M.R.P.	₹2900.00
STD. PACKING	10

DOMESTIC WASHER & DOMESTIC VACUUM CLEANER (CLEANING SOLUTION)

Induction Washer | EPW-1690

HSN-84248990



Working Pressure	90 Bar
Max. Pressure	130 Bar
Water Flow Rate	6.5 L/min
Rated Input Power	1600 W
Net Weight	11.000 kg
M.R.P.	₹ 14,500.00
Std. Packing	2

Domestic Vacuum Cleaner | EVC-030NE

HSN-85086000



Capacity	25 litre
Suction	18 KPa
Rated Input Power	1200 W
Net Weight	8.000 kg.
M.R.P.	₹ 12,300.00
Std. Packing	1



Handy Vacuum | Blower EHVC-800

HSN-85081100



Product Code	EHVC-800
Suction	16 KPA
Rated Input Power	800 W
Net Weight	1.8 Kgs
M.R.P.	₹ 5900.00
Std. Packing	4

INDUSTRIAL VACUUM CLEANER (CLEANING SOLUTION)

Industrial Vacuum Cleaner | EVC-015

HSN-85081100



Capacity	15 Litre
Suction	20 KPa
Rated Input Power	1000 W
Net Weight	11.00 kg.
M.R.P.	₹ 21,500.00
Std. Packing	1

Industrial Vacuum Cleaner | EVC-030

HSN-85086000



Capacity	30 litre
Suction	20 KPa
Rated Input Power	1000 W
Net Weight	14.000 kg.
M.R.P.	₹ 26,400.00
Std. Packing	1

Industrial Vacuum Cleaner | EVC-060

HSN-85086000



Product Code	EVC-060
Capacity	60 Litre
Suction	20 KPa
Rated Input Power	3 x 1000 W
Net Weight	28.000 kg.
M.R.P.	₹ 49,500.00
Std. Packing	1

Arc Welding Set | EAWSI-200

HSN-84682010



ADVANCED IGBT TECHNOLOGY
FAN COOLED

new Launch

Welding Current	20-200 A
Frequency	50/60 Hz
Rated Input Voltage	160-250 V
Net Weight	4.00 kg.
M.R.P	₹ 13,800.00
Std. Packing	4

in JRS Brand

Air Compressor | EAC-60150

HSN-84144090

- With Double Piston • LED Light for Night Vision Usage
- Alligator Switch for emergency Use through battery terminal



new Launch

Voltage	12 V
Max. Current	25 A
Max. Displacement	60 Ltr./Min
Max Atmospheric Pressure	150 PSI
MRP	₹ 5200.00
Std. Packing	8

1/2" Air Impact Wrench | EAIW-949

HSN-84672900



new Launch

Max. Torque	1220 Nm
Working Torque	68-949 Nm
No Load Speed	9000 RPM
Hose Size	10 mm
Net Weight	2.700 kg.
M.R.P	₹ 14,800.00
Std. Packing	8

ACCESSORIES

Cutting / Grinding Wheels - Professional Quality

- Material : Made from Selected High Quality Abrasive & Re-inforced by Fibre Glass Net
 Characteristics : High Tensile & Anti-shock strength & resistance to bending
 Application : Metallic and Non-Metallic cutting & grinding



ITEM NAME	DESCRIPTION SIZE	PRICE EACH ₹	INNER PACKING	CARTON PACKING
ECW-107A	Cutting Wheel 4" Black (1 mm Thickness), Bore Dia 16 mm	35.00	50	600
ECW-107G	Cutting Wheel 4" Green (1 mm Thickness), Bore Dia 16 mm	40.00	50	600
ECW-107N	Cutting Wheel 4" Brown (1 mm Thickness), Bore Dia 16 mm	45.00	50	800
ECW-125N	Cutting Wheel 5" Green (1.2 mm Thickness), Bore Dia 22.23 mm	60.00	50	400
ECW-355A	Cutting Wheel 14" Black (2.8 mm Thickness), Bore Dia 25.40 mm	210.00	25	25
ECW-355G	Cutting Wheel 14" Green (2.8 mm Thickness), Bore Dia 25.40 mm	240.00	25	25
ECW-355G-N2	Cutting Wheel 14" Green (2.8 mm Thickness), Bore Dia 25.40 mm	250.00	25	25
EGW-100	Grinding Wheel 4" Black (6.2 mm Thickness), Bore Dia 16 mm	35.00	25	200
EGW-125	Grinding Wheel 5" Black (6.2 mm Thickness), Bore Dia 22.23 mm	60.00	25	100
EGW-180	Grinding Wheel 7" Black (6.7 mm Thickness), Bore Dia 22.23 mm	120.00	25	25

Marble Cutter Blades

- Material : C40 Body
 Characteristics : Durable Long Life
 Application : Used for Cutting Marble, Graphite, Kota & Tiles

Code	Dia	Inner Hole	M.R.P (₹)
FAPEMB-110N	110	20/16	210.00
FAPEMB-125N	125	22.25/20/16	260.00



Flap Disc 4 | EFD-100

Available in 60, 80, 120 GRIT



Disc Dia	100 mm
Inner dia	16 mm
Total Flaps	72
Flap size	24 x 16 mm
Material	Cal-AO
Packing	20 pcs Inner color box, 200 pcs outer color box.
MRP	58 (Incl. of GST)

TCT Circular Saw Blades

- Material : Steel Body & Tungsten Carbide Tips
 Characteristics : Original YGB Tips Professionally designed for cutting
 Application : Cutting Dry, Hard & Soft Wood & Shaving & Wood Fibre Boards



Code	Wheel Dia Inch	Wheel Dia mm	Wheel Thickness	Kerf	Wheel Bore Dia	Teeths	M.R.P (₹)
TCT 4X30T	4	110	1.2	1.8	20.00	30	190.00
TCT 4X40T	4	110	1.2	1.8	20.00	40	210.00
TCT 5X40T	5	125	1.2	1.8	25.40	40	240.00
TCT 7X40T	7	180	1.3	2.2	25.40	40	350.00
TCT 7X60T	7	180	1.3	2.2	25.40	60	450.00
TCT 8X40T	8	200	1.5	2.2	25.40	40	490.00
TCT 8X60T	8	200	1.5	2.2	25.40	60	550.00
TCT 10X40T	10	250	2.0	3.0	25.40	40	610.00
TCT 10X60T	10	250	2.0	3.0	25.40	60	700.00
TCT 12X120T*	12	300	2.0	3.0	25.40	120	1890.00

* FOR ALUMINIUM

CHISEL BITS



ITEM CODE	DESCRIPTION SIZE	PRICE EACH ₹	INNER PACKING	CARTON PACKING
FAPECHB400-F	CHISEL BIT 400X18MM-FLAT (11 Kg.)	350.00	01	25
FAPECHB400-P	CHISEL BIT 400X18MM-POINTED (11 Kg.)	350.00	01	25
FAPECHB05-F	CHISEL BIT 5KG HAMMER FLAT 400X18M	300.00	01	25
FAPECHB05-P	CHISEL BIT 5KG HAMMER POINTED 400X18M	300.00	01	25
FAPECHB16-P	CHISEL BIT 16KG HAMMER POINTED 400X30MM	650.00	01	10
FAPECHB16-F	CHISEL BIT 16KG HAMMER FLAT 400X30MM	650.00	01	10

Magnetic Nut Runner (Order in Sets only)

Magnetic Nut Runner 8 X 65 mm

Magnetic Nut Runner 10 X 65 mm



EMNR-865

Driven Size	8mm
Length	65 mm
Material	CrV
HRC	48-52
Packing	5 pcs in set, 200 set in master CARTON
MRP(Per Set)	190 (Incl. of GST)



EMNR-1065

Driven Size	10mm
Length	65 mm
Material	CrV
HRC	48-52
Packing	5 pcs in set, 200 set in master CARTON
MRP(Per Set)	210 (Incl. of GST)

Drill Chucks

Code	Size mm	Inner Packing	CARTON Packing	M.R.P (₹)
EDCK-10	10	1	50	250.00
EDCK-13	13	1	50	295.00



Diamond Rim Blade

- Material : C40 Body
 Characteristics : Durable Long Life
 Application : Used for Cutting Marble, Graphite, Kota & Tiles

new Launch

Code	Dia	Inner Hole	M.R.P (₹)
ERBC-110	110	16/20	190.00



At Eastman we design our products for long service life. To give you additional peace of mind for your investment we offer 6 months warranty on our tools from the date of purchase. The warranty applies only against any manufacturing defects. If tool becomes defective during operation due to faulty material or workmanship within the warranty period, Eastman undertakes to correct the defect without any charge. Parts covered in warranty are

- 1) Armature
- 2) Field Coil

This Warranty DOES NOT Apply to:

1. All normal wear & tear of parts e.g. Carbon Brushes, Cord, Chuck and other consumable parts.
2. Attachments and Accessories supplied with the tool.
3. Unauthorized repair, alteration / modifications done by other agencies.
4. Damage caused by foreign objects, extraneous substance, accidents, obvious misuse, abuse, neglect and improper application.
5. Improper supply conditions of voltage and frequency.
6. Gun & Pipe in case of Pressure Washer.
7. Attachments in case of Vacuum Cleaner.



*These terms cover the general warranty for the product. This warranty is not assignable or transferable.

NEW HOLLAND-NDEL



ITEM CODE	CONTENTS	PRICE EACH ₹	INNER PACKING	CARTON PACKING
	• DOE 10x13, 17x19 • Slip Joint Plier 6" • Screw Driver 608 & 806 • Wheel Spanner 19x24 • Tommy Bar NO. 6 • Guide Pins (2 Nos.) • Canvas Kit Roll • Grease Gun	1950.00	1	8

NEW HOLLAND (FORD) TRACTOR-50 HP



ITEM CODE	CONTENTS	PRICE EACH ₹	INNER PACKING	CARTON PACKING
	• DOE 10x13, 17x19 (2 Nos.) • Grease Gun 04 oz • Slip Joint Plier 6" • Screw Driver 608 & 806 • Wheel Spanner 19x24 • Tommy Bar No. 6 • Guide Pins (2 Nos.) • Canvas Kit Roll	1739.00	1	8

SONALIKA TRACTOR-ITL



ITEM CODE	CONTENTS	PRICE EACH ₹	INNER PACKING	CARTON PACKING
	• DOE 10x11, 12x13 • Ring Spanner 18x19, 24x32 • Screw Driver 810 • Slip Joint Plier 6" • Canvas Bag	820.00	1	16

MAHINDRA & MAHINDRA TRACTOR



ITEM CODE	CONTENTS	PRICE EACH ₹	INNER PACKING	CARTON PACKING
	• DOE 10x11, 12x13, 1/2x9/16, 3/4x5/8 SAE • Ring Spanner 1-1/8, 15x16 SAE • Slip Joint Plier 6" • Screw Driver 808 • Canvas Tool Bag	627.00	1	16

MAHINDRA & MAHINDRA TRACTOR - ARJUN



ITEM CODE	CONTENTS	PRICE EACH ₹	INNER PACKING	CARTON PACKING
	• DOE 14x17, 20x22, 1/2x9/16, 3/4x5/8 SAE • DOE 10x11, 12x13 • Screw Driver 808 Flat • Wheel Spanner 15/16x1 - 18 SAE • Slip Joint Plier 6" • Tommy Bar No. 4 • Canvas Bag	1419.00	1	16

MAHINDRA & MAHINDRA -BOLERO / SCORPIO



ITEM CODE	CONTENTS	PRICE EACH ₹	INNER PACKING	CARTON PACKING
	• DOE 8x10, 12x13 • Tool Bag	75.00	1	50

TATA-ACE



ITEM CODE	CONTENTS	PRICE EACH ₹	INNER PACKING	CARTON PACKING
	• DOE 8x10 • Screw Driver 606R Reversible • L-Type Spanner - 18mm A/F • Tool Bag	276.00	1	10

TATA - 1613 HCV



ITEM CODE	CONTENTS	PRICE EACH ₹	INNER PACKING	CARTON PACKING
	• Ring Spanner 24x27 • Screw Driver 806 • Wheel Spanner 30-32 A/F • Tommy Bar No. 5 • Tool Bag	1403.00	1	5

TATA - 709



ITEM CODE	CONTENTS	PRICE EACH ₹	INNER PACKING	CARTON PACKING
	• DOE 8x10, 13x16, 18x21 • Hex Allen Key 08 • Screw Driver 806 • Tubular Box Spanner 27 A/F • Tommy Bar No. 5 • Tool Bag	1305.00	1	6

TATA - 1109 HCV



ITEM CODE	CONTENTS	PRICE EACH ₹	INNER PACKING	CARTON PACKING
	• DOE 8x10, 9x11, 13x16 • Ring Spanners 24x27 • Screw Driver 806 • Wheel Spanner 27-30 A/F • Tommy Bar No. 5 • Tool Bag	1553.00	1	5

TAFE - SAMART



ITEM CODE	CONTENTS	PRICE EACH ₹	INNER PACKING	CARTON PACKING
	• DOE 10x11, 12x13, 14x15, 16x17, 18x19, 24x27 • Screw Driver 608 Flat • Ring Spanner 5/8x11/16, 19x22, 24x27	684.00	1	16

PUNJAB TRACTORS LTD.



ITEM CODE	CONTENTS	PRICE EACH ₹	INNER PACKING	CARTON PACKING
	• DOE 10x11, 12x13, 14x17, 19x22 • Ring Spanner 24x32 • Screw Driver 806 R • Slip Joint Plier 6" with Sleeve • Tool Bag	644.00	1	16

EICHER - 3666 / 3639



ITEM CODE	CONTENTS	PRICE EACH ₹	INNER PACKING	CARTON PACKING
	• DOE 10x12, 14x17, 19x22, 24x27 • Screw Driver 786 R • Slip Joint Plier 6" • Adjustable Wrench 8 • Tool Pouch	734.00	1	20

TVS XL - 100



ITEM CODE	CONTENTS	PRICE EACH ₹	INNER PACKING	CARTON PACKING
	• DOE 17x19 • Screw Driver - 605 • Tool Bag	734.00	1	20

TOOL KIT FOR SONALIKA REAPER



ITEM CODE	CONTENTS	PRICE EACH ₹	INNER PACKING	CARTON PACKING
TOOL KIT RTV	• DOE Spanner 12x13, 16x17, 22x24 • Ring Spanner 12x13, 19x22 • Grease Gun: 8 OZ with Fix Spout Black	2608.00	1	20

JOHN DEERE



ITEM CODE	CONTENTS	PRICE EACH ₹	INNER PACKING	CARTON PACKING
	• DOE 10x12, 14x15, 13x16, 24x26 • Combination Plier 6" • Screw Driver 806 • Wheel Spanner 13/16x15/16 • Tommy Bar No.1 • Wheel Spanner 27 AF • Grease Gun 08 OZ • Tool Bag	2323.00	1	6

ASHOK LEYLAND - HCV



ITEM CODE	CONTENTS	PRICE EACH ₹	INNER PACKING	CARTON PACKING
	• DOE 10x11, 18x19 • Adjustable Wrench 8" • Screw Driver 808 • Canvas Packing	670.00	1	20

TVS JUPITER



ITEM CODE	CONTENTS	PRICE EACH ₹	INNER PACKING	CARTON PACKING
	• DOE 10x12 • Screw Driver- 605 • Tool Bag			

CONVERSION CHART OF METRIC, SAE AND WHIT WORTH SIZES

S.NO.	SAE	MM	S.NO.	SAE	MM	S.NO.	SAE	MM	S.NO.	SAE	MM
1	1/4	6.35	17	1	25.40	1	1/16	6.50	17	1	42.42
2	5/6	7.94	18	1.1/16	26.90	2	3/32	7.54	18	1.1/8	47.24
3	11/32	8.73	19	1.1/8	28.57	3	1/8	8.64	19	1.1/4	52.07
4	3/8	9.52	20	1.3/16	30/16	4	3/16	11.30	20	1.3/8	56.39
5	19/32	10.32	21	1.184	31.75	5	1/4	13.33	21	1.1/2	62.21
6	7/16	11.11	22	1.5/16	33.34	6	5/16	15.24	22	1.5/8	65.53
7	1/2	12.70	23	1.3/8	34.92	7	3/8	18.03	23	1.3/4	70.10
8	9/16	14.29	24	1.7/16	36.51	8	7/16	20.83			
9	19/32	15.08	25	1.1/2	38.10	9	1/2	23.37			
10	5/8	15.88	26	1.9/16	39.69	10	9/16	25.65			
11	11/16	17.46	27	1.5/8	41.28	11	5/8	27.94			
12	3/4	19.05	28	1.11/16	42.86	12	11/16	30.48			
13	25/32	19.84	29	1.3/4	44.45	13	3/4	33.00			
14	13/16	20.64	30	1.13/16	46.04	14	13/16	35.30			
15	7/8	22.22	31	1.7/8	47.72	15	7/8	37.59			
16	15/16	23.81	32	2	50.80	16	15/16	40.13			

SAE : SAE is the abbreviation of Society of Automotive Engineers (USA) ½ means ½" distance across flats of bolts, screw heads and nuts.

MM : In case of MM, the distance across flats is indicated in millimeters, 12 MM means 12 millimeters distance across flats of bolts, screw heads and nuts.

WW : WW is the abbreviation for Whitworth (U.K.) and it indicated diameter of the bolt or screw 1/8 ww means diameter for the bolt as 1/8 inch and does not indicate distance across flats.

Our Satisfied O.E.M Customers



PRICE LIST TERM & CONDITIONS

- The price and specifications may change.
- Interest @15% shall be charged if payment is received after 45 days from date of invoice strictly.
- All prices are maximum retail prices and are inclusive of goods & services tax.
- Illustrations and pictures in this price list are as true as possible, but not binding.
- All prices are for Destination. (Up to transporter godown)
- All orders will be in Standard packing.
- This cancels our previous price list.
- All the models & their properties, are only few for reference purpose & can be changed without any prior notice.

POWER TOOLS SERVICES CENTRES TO FACILITATE CUSTOMER SERVICE

LUDHIANA
Ganpati Tower, Gill Road,
Ludhiana (Punjab)
Ph: + 91-97818-04455
E: showroomldh@eastmanhandtools.com

CHANDIGARH
SCO: 132/1, Opp. Govt. School,
Vill. Burail, Sector 45A, Chandigarh
Ph.: 0175-5007139,
M.: +91-87250-88314, 87250-88355
80540-33305

BATHINDA
Shop No. 5226, St. No. 6,
Opp. Public Dharmashala, Malviya Nagar,
Nai Basti, Bathinda (Punjab)
Ph.: 0164-5011919, M: +91-87250-88335
E: bat@eastmanhandtools.com

AMRITSAR
247 A, 100 Ft. Road,
East Mohan Nagar
Amritsar (Punjab)
M: +91-87250-88322
E: asr@eastmanhandtools.com

NEW DELHI
Off. No. 101, 1st Floor,
1 Community Centre
Naraina Industrial Area, New Delhi
M: +91-11-45578059, 77400-94501
E: ptdel@eastmanhandtools.com

RAJASTHAN
Bagada Sadan, 1st Floor, S.C. Road,
Jaipur (Rajasthan)
Ph.: 0141-2372838, M: +91-87250-88388
E: jpr@eastmanhandtools.com

KARNATAKA
1st Floor, Krishnalaya Complex No. 26
N.R. Road, 4th Cross, Bengaluru (Karnataka)
Ph.: 080-41695388, M: +91-78299-99109
E:blr@eastmanhandtools.com

GUJARAT
Sales & Services
M: +91-99880-33304
+91-87250-88341

TAMILNADU
Sales & Services
M: +91-77400-94502

ANDHRA PRADESH / TELANGANA
Sales & Services
M: +91-75270-28302

KERALA
Sales and Services
M: +91-87250-88365,
+91-86063-14144

HARYANA
Sales & Services
M: +91-8720-01386

JAMMU & KASHMIR
Sales & Services
M: +91-70095-61205

WEST BENGAL
Sales and Services
M: +91-99880-99947

ORISSA
Sales & Services
M: +91-75270-28313

UTTAR PRADESH / UTTARAKHAND
Sales & Services
M: +91-88407-95710
M: +91-75270-28306

CHHATTISGARH
Sales & Services
M: +91-83603-73608

HIMACHAL PRADESH
Services
M: +91-80540-33305,
87250-88307, 87250-88309

MAHARASHTRA
Sales & Services
M: +91-80540-33305
75270-28304, 99880-33305
E: salespunjab@eastmanhandtools.com

MADHYA PRADESH
Sales & Services
M: +91-83603-71973

NORTH EAST
Sales and Services
M: +91-75270-28310

BIHAR/JHARKHAND
Sales & Services
M: +91-95231-40808

IN CASE OF NO RESPONSE PLEASE CALL
87250-88322 | 18005723101

 **Eastman**® **CAST & FORGE LTD.**

G.T. Road, Near Airport, Ludhiana - 141120, Punjab (INDIA),
Tel. : +91-161-5211000, 71-75, +91-161-2511440-41
Fax : +91-161-2511444, E-mail : ecfl@eastmanhandtools.com
Website : www.eastmanhandtools.com, www.eastmanshop.com
Toll Free No. : 18005723101

THIS PRICE LIST SUPERCEDES ALL OUR PREVIOUS PRINTED & CORRECTED PRICE LISTS